

BLACK+ DECKER™

**14,000 BTU
PORTABLE AIR CONDITIONER
WITH HEAT PUMP**

INSTRUCTION MANUAL

**CATALOG NUMBER
BPACT14H****

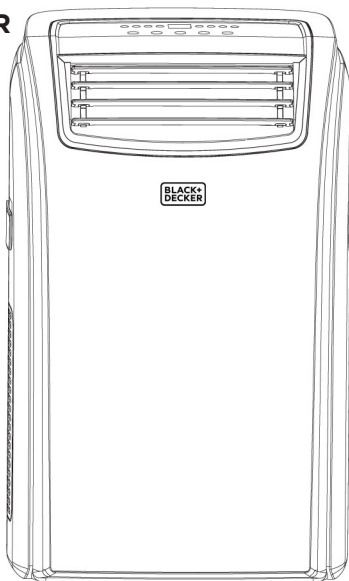

Thank you for choosing BLACK+DECKER!

PLEASE READ BEFORE RETURNING THIS PRODUCT FOR ANY REASON.

If you have a question or experience a problem with your BLACK+DECKER purchase, go to www.blackanddecker.com/instantanswers

If you can't find the answer or do not have access to the Internet, call 844-299-0879 from 10:30 a.m. to 6:30 p.m. EST Mon. - Fri. to speak with an agent. Please have the catalog number available when you call.

SAVE THIS MANUAL FOR FUTURE REFERENCE.

CONTENTS

SAFETY INFORMATION

Important Safety Instructions.....	3-4
Grounding Instructions.....	5
Safety Guidelines	6
Power Cord Operation.....	7

SET UP & USE

Parts & Features	8
Specifications	9
Installation Guide	9
Window Slider Kit Installation.....	10
Exhaust Hose Installation.....	11
Control Panel.....	12
Operating from the Control Panel.....	12-13
Control Panel on Remote Control	14
Operating from the Remote Control.....	15-17
Water Drainage	18-20

CLEANING & CARE	19
----------------------------------	----

TROUBLE SHOOTING & WARRANTY

Before You Call For Service.....	21
Customer Service.....	21
Troubleshooting.....	22
Limited Warranty.....	23

PRODUCT REGISTRATION

Thank you for purchasing our BLACK+DECKER product. This easy-to-use manual will guide you in getting the best use of your air conditioner.

Remember to record the model and serial numbers. They are on a label on the rear.

Model number

Serial number

Date of purchase

Staple your receipt to your manual.
You will need it to obtain warranty service.

SAFETY INFORMATION



DANGER

DANGER - Immediate hazards which **WILL** result in severe personal injury or death



WARNING

WARNING - Hazards or unsafe practices which **COULD** result in severe personal injury or death



CAUTION

CAUTION - Hazards or unsafe practices which **COULD** result in minor personal injury

IMPORTANT SAFETY INSTRUCTIONS



WARNING

When using electrical appliances, basic safety precautions should be followed, including the following

1. Air conditioner must be connected to proper electrical outlet with the correct electrical outlet with the correct electrical supply.
2. Proper grounding must be ensured to reduce the risk of shock and fire. **DO NOT CUT OR REMOVE THE GROUNDING PRONG.** If you do not have a three-prong electric receptacle outlet in the wall, have a certified electrician install the proper receptacle. The wall receptacle **MUST** be properly grounded.
3. Do not operate air conditioner if power cord is frayed or otherwise damaged. Avoid using it if there are any cracks or abrasion damage along the length, plug connector or if the unit malfunctions or is damaged in any manner. Contact an authorized service technician for examination, repairs or adjustments.
4. **DO NOT USE AN ADAPTER OR AN EXTENSION CORD.**
5. Do not block airflow around the air conditioner. The exhaust hose should be free of any obstructions.
6. Always unplug the air conditioner before servicing it or moving it.
7. Do not install or use the air conditioner in any area where the atmosphere contains combustible gases or where the atmosphere is oily or sulphurous. Avoid any chemical coming in contact with your air conditioner.
8. Do not place any object on the top of the unit.
9. Never operate the air conditioner without filters in place.
10. Do not use the air conditioner near a bathtub, shower or wash basin.

SAVE THESE INSTRUCTIONS
HOUSEHOLD USE ONLY

SAFETY INFORMATION

HANDLING ALKALINE BATTERIES

WARNING

When handling alkaline batteries, basic safety precautions should be followed, including the following

1. Should fluid from the battery accidentally get into your eyes, there is a threat of loss of eyesight, do not rub them. Immediately rinse your eyes with clean tap water and then consult a physician immediately.
2. Do not put the battery in a fire, expose it to heat, dismantle or modify it. If the insulation or safety valve is damaged, the battery may leak fluid, overheat or explode.
3. Do not insert the battery with the poles reversed. Doing so may cause some abnormality or a short and the battery may leak fluid, overheat or explode.
4. Keep the battery out of the reach of children. If the battery is swallowed, contact a physician immediately.
5. If the alkali fluid gets in your mouth, rinse your mouth with water and contact a physician immediately.
6. If the alkali fluid gets on your skin or clothes, it may burn your skin, thoroughly rinse the affected area with tap water.
7. Do not mix new and old batteries or other makes of batteries. The different attributes may cause the battery to leak fluid, overheat or explode.
8. This battery was not made to be recharged. Recharging this battery may damage the insulation or internal structure and may cause the battery to leak fluid, overheat or explode.
9. Do not damage or remove the label on the exterior of the battery. Doing so may cause the battery to short, leak fluid, overheat or explode.
10. Do not drop, throw or expose the battery to extreme impact. Doing so may cause the battery to leak fluid, overheat or explode.
11. Do not alter the shape of the battery. If the insulation or safety valve is damaged, the battery may leak fluid, overheat or explode.
12. Immediately remove batteries when they have lost all power. Leaving the batteries in the unit for a long time may cause the batteries to leak fluid, overheat or explode due to gas that is generated by the batteries.
13. Remove the batteries from the unit when not using the unit for an extended period of time. The batteries may leak fluid, overheat or explode due to gas that is generated by the batteries.
14. Do not apply solder directly to the batteries. The heat may cause the batteries to leak fluid, overheat or explode.
15. Do not get the batteries wet. Doing so may cause the batteries to overheat
16. Store batteries someplace out of direct sunlight where the temperature and humidity are not high. Not doing so may cause the batteries to leak fluid, overheat or explode. Also, it may cause the life and performance of the batteries to decline.
17. Follow the regulations of the local government when disposing of these batteries.

SAVE THESE INSTRUCTIONS
HOUSEHOLD USE ONLY

SAFETY INFORMATION

GROUNDING INSTRUCTIONS

ELECTRICAL REQUIREMENTS

The electrical requirements are a 115 volt 60 Hz, AC only, 15 amp. It is recommended that a separate circuit serving only the product be provided. The product is equipped with a 3-wire cord having a 3-prong grounding plug. It must be plugged into a wall receptacle that is properly installed and grounded.

This appliance must be grounded. In the event of an electrical short circuit, grounding reduces risk of electric shock by providing an escape wire for the electric current. The cord provided with this appliance is equipped with a grounding wire and a grounding plug. The plug must be plugged into an outlet that is properly installed and grounded.

Avoid the use of three prong adapters or cutting off the third grounding prong in order to accommodate a two prong outlet. This is a dangerous practice since it provides no effective grounding for the air conditioner and may result in shock hazard.

WARNING

Improper use of the grounding plug can result in a risk of electric shock.

Consult a qualified electrician or serviceman if:

- 1) The grounding instructions are not completely understood.
- 2) You are unsure that the appliance is properly grounded.
- 3) You have any questions about the grounding or electrical instructions.

POWER SUPPLY CORD

1. Avoid the use of an extension cord because of potential safety hazards under certain conditions. Have a qualified electrician or serviceman to install an outlet near the appliance.
2. If it is absolutely necessary to use longer cord sets or an extension cord, extreme care must be exercised.
 - a) Use only a grounding type 3-wire extension cord that has a 3-blade grounding plug and a 3-slot receptacle that will accept the plug on the appliance.
 - b) The marked electrical rating of the cord set or extension cord must equal to or greater than the electrical rating of the appliance. The longer cord should be arranged so that it will not drape over the counter top or table top where it can be pulled on by children or tripped over unintentionally.

NOTE: Neither BLACK+DECKER nor the dealer can accept any liability for damage to the product or personal injury resulting from failure to observe the electrical connection procedures.

SAFETY INFORMATION

SAFETY GUIDELINES

To prevent injury to the user or other people and property damage, the following instructions must be followed. Incorrect operation due to ignoring of instructions may cause harm or damage.

ALWAYS DO THIS	NEVER DO THIS	ENERGY SAVE
<ul style="list-style-type: none"> • Your air conditioner should be used in such a way that it is protected from moisture. e.g. condensation, splashed water, etc. Do not place or store your air conditioner where it can fall or be pulled into water or any other liquid. Unplug immediately. • Always transport your air conditioner in a vertical position and stand on a stable, level surface during use. • Turn off the product when not in use. • Always contact a qualified person to carry out repairs. If the supply cord is damaged it must be repaired by a qualified technician. • Keep an air path of at least 12 inches. all around the unit from walls, furniture and curtains. • If the air conditioner is knocked over during use, turn off the unit and unplug from the power supply immediately. 	<ul style="list-style-type: none"> • Do not operate your air conditioner in a wet room such as a bathroom or laundry room. • Do not touch the unit with wet or damp hands or when barefoot. • Do not press the buttons on the control panel with anything other than your fingers. • Do not remove any fixed covers. Never use this appliance if it is not working properly, or if it has been dropped or damaged. • Never use the plug to start and stop the unit. • Always use the switch on the control panel to start or shut off the unit. • Do not cover or obstruct the inlet or outlet grilles. • Do not use hazardous chemicals to clean or come into contact with the unit. Do not use the unit in the presence of inflammable substances or vapour such as alcohol, insecticides, petrol, etc. • Do not allow children to operate the unit unsupervised. • Do not use this product for functions other than those described in this instruction manual. 	<ul style="list-style-type: none"> • Use the unit in the recommended room size. • Locate the unit where furniture cannot obstruct the air flow. • Keep blinds/curtains drawn. • Keep the filters clean. • Keep doors and windows closed to keep cool air in and warm air out.

SAFETY INFORMATION

POWER CORD OPERATION

The power supply cord contains a current device that senses damage to the power cord. To test your supply cord follow these steps:

1. Plug in the Air Conditioner.
2. The power supply cord head has two buttons, a TEST button and a RESET button. Press the TEST button and notice a click as the RESET button pops out.
3. Press the RESET button. Once again notice a click as the button engages.
4. The power supply cord will now supply electricity to the unit.

NOTE:

- Do not use this device to turn the unit on or off.
- Always make sure the reset button is pushed in for correct operation
- The power supply cord must be replaced if it fails to reset when either the test button is pushed, or it cannot be reset.
- If power supply cord is damaged, it cannot be repaired.
- It must be replaced by one obtained from the product manufacturer.
- After the unit has stopped, the compressor operate for the first 3 minutes. This is to protect the unit. Operation will automatically start after 3 minutes.

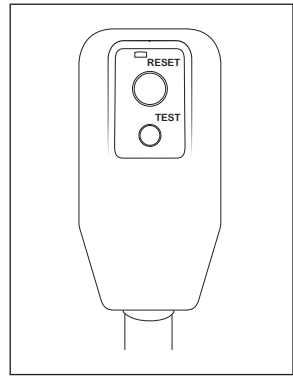

OPERATING CONDITION

The air conditioner must be operated within the temperature range indicated below:

NOTE: · Unit performance may be affected when in use outside of these operating temperatures.

MODE	ROOM TEMPERATURE
COOL	64 °F (18 °C) ~ 95 °F (35 °C)
DRY	64 °F (18 °C) ~ 95 °F (35 °C)
HEAT	50 °F (10 °C) ~ 77 °F (25 °C)

SET UP & USE

PARTS & FEATURES

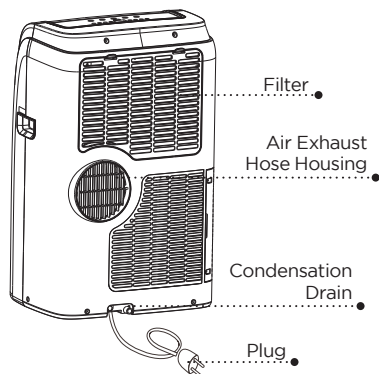
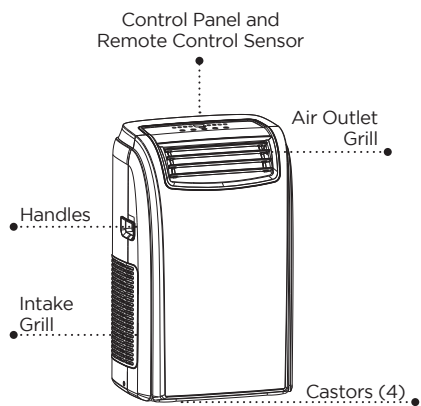

Air Exhaust Hose

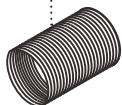

Hose Outlet



Hose Inlet



Castor Locks



Metal Locking Screw

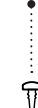

Window Bracket /
Air Exhaust Hose
Connector

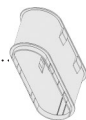

Metal Locking Screw



Window Bracket

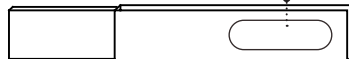

Drain Hose



Remote
Control



Foam Seal

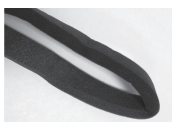

SET UP & USE

SPECIFICATIONS

BPACT14H

- Unit Dimensions (W x D x H): 17.1" x 13.8" x 28.1"
- Unit Weight: Approx. 68.3 lbs.
- Electric Requirements: 115V ~ 60Hz
- Performance Rating: 14,000 BTU Cool, 10,000 BTU Heat

INSTALLATION GUIDE

LOCATION

- The air conditioner should be placed on a firm floor to minimize noise and vibration. For safe and secure positioning, place the unit on a smooth, level floor strong enough to support the unit.
- The unit has casters to aid placement, but it should be rolled on smooth, flat surfaces. Use caution when rolling on carpet surfaces. Do not attempt to roll the unit over objects.
- The unit must be placed within reach of a properly rated grounded socket.
- Never place any obstacles around the air inlet or outlet of the unit.
- Allow 12 inches to 36 inches of space from the wall with window for efficient air-conditioning.

SUGGESTED TOOLS FOR WINDOW KIT INSTALLATION

- Screwdrivers (medium size Phillips)
- Tape measure or ruler
- Knife or scissors
- Saw (In the event that the window kit needs to be cutdown in size because the window is too narrow for direct installation)

SET UP & USE

WINDOW SLIDER KIT INSTALLATION

Your window slider kit has been designed to fit most standard "Vertical" and "Horizontal" window applications; however, it may be necessary for you to improvise/modify some aspect of the installation procedures for certain types of window. Minimum and maximum window openings:

MAXIMUM : 59" (145 cm)

NOTE: A plastic locking pin is holding the window slider kit together during shipment. Prior to installation, remove plastic locking pin, adjust to desired length and use provided metal locking screws to secure.

NOTE: If the window opening is less than 20.5" the minimum length of the window slider kit, cut the one with a hole in it short to fit for the window opening. Never cut out the hole in window slider kit.

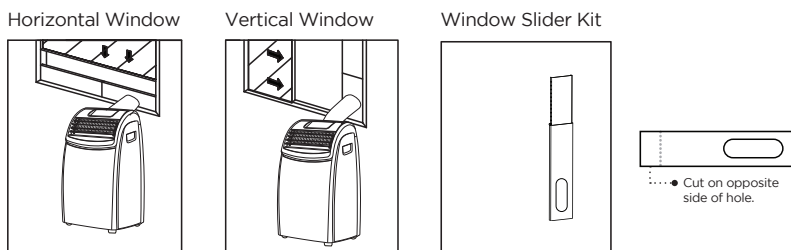

DOUBLE-HUNG SASH/SLIDING CASEMENT WINDOW INSTALLATION

1. Cut the foam seal (adhesive type) to the proper length and attach it to the window sash.
2. Attach the window slider kit to the window sash. Adjust the length of the window slider kit according to the width of window. Shorten the adjustable window kit if the width of window is less than 20.5".
3. Cut the foam seal (adhesive type) to the proper length and attach it on the top of the window.
4. Close the window securely against the window slider kit.
5. Secure the window slider kit to the window sash.
6. Cut the foam seal to an appropriate length and seal the open gap between the top window frame and outer window frame.

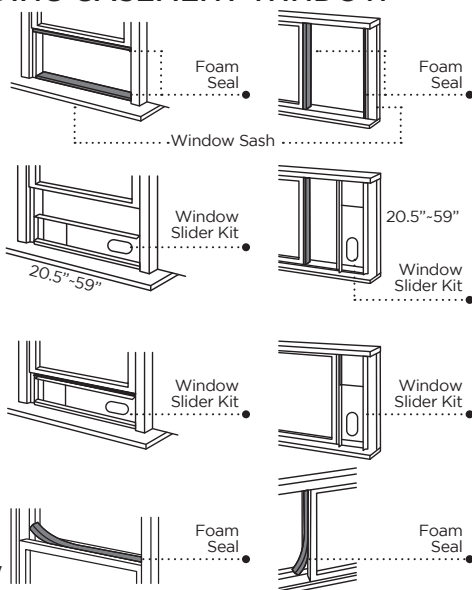

SET UP & USE

EXHAUST HOSE INSTALLATION

The air exhaust hose and hose inlet must be installed or removed from the portable air conditioner in accordance with the way it is being used:

COOL, AUTO: Air exhaust hose and hose inlet should be connected to the portable air conditioner.

DEHUMIDIFY, FAN: Air exhaust hose and hose inlet should be disconnected from the portable air conditioner.

To install:

1. Connect hose inlet to one end of air exhaust hose. Push hose inlet over the end of the hose, push in slightly and then start threading it on in a counter clockwise direction. (see Fig 1)
2. Connect hose outlet to other end of air exhaust hose. Push hose outlet over the end of the hose, push in slightly and then start threading it on in a counter clockwise direction. (see Fig 2)
3. Align window bracket/air intake hose connector with hose outlet and push in until it locks into place. You will hear a clicking sound when it does. (see Fig 3)
4. Place the hose inlet against the air outlet opening hook on the back of the portable air conditioner and firmly push and rotate counter clockwise to lock it into place. (see Fig 4)
5. After connecting the hose inlet to the unit, insert the window bracket/air intake hose connector into the opening of the window bracket. Align connector with the opening on the inside (side with the channels) of the window bracket and push in until it locks into place. You will hear a clicking sound when it does. (see Fig 5).

Fig. 1

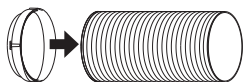

Fig. 2

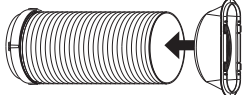

Fig. 3

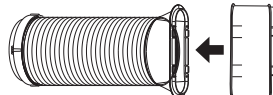

Fig. 4

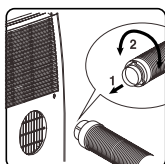
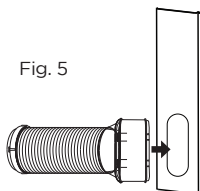
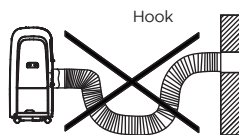

Fig. 5



NOTE: The exhaust hose can be compressed or extended moderately, but it is desirable to keep the length to a minimum. Also make sure that the hose does not have any sharp bends.



SET UP & USE

CONTROL PANEL

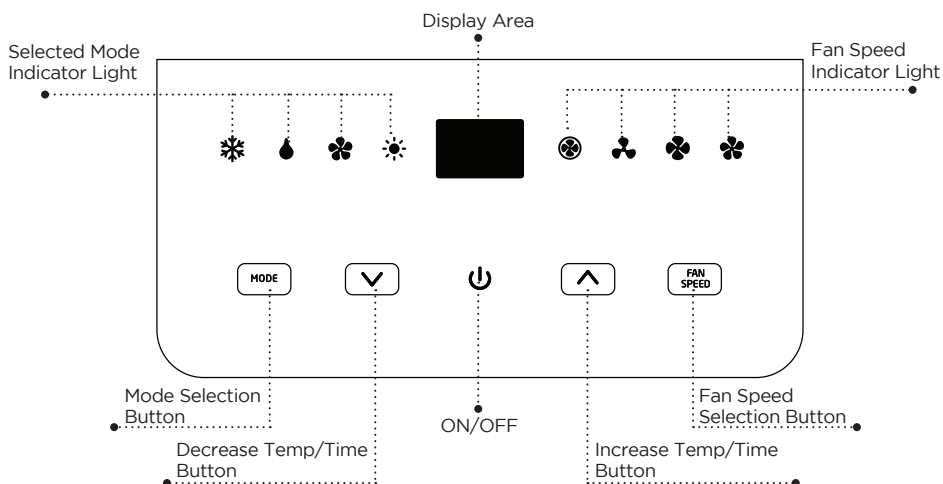

Pictures are for illustration purpose only. Your model may or may not have all the features.



OPERATING FROM THE CONTROL PANEL

The Control Panel enables you to manage all the main functions of the appliance, but to fully exploit its potential, you must use the remote control unit.



Fig. 6

TURNING THE APPLIANCE ON

- Plug into the dedicated electrical outlet. Two lines appear on the display indicating that the appliance is in standby. (Fig. 6)
- Press the  button until the appliance comes on. The last function active when it was turned off will appear.
- * Never turn the air conditioner off by unplugging from the mains. Always press the , then wait for a few minutes before unplugging. This allows the appliance to perform a cycle of checks to verify operation.

Note: Before pressing Power On button make sure the condensate drain plug in the rear of the unit is securely in place to avoid any leaking.

- Press the MODE button until the light corresponding to the required Mode lights up.



SET UP & USE

COOL MODE

Ideal for hot muggy weather when you need to cool and dehumidify the room. To set operation of the appliance correctly, press the **▲** or **▼** buttons until the desired temperature is displayed. (See Fig. 7)



Fig. 7

Then select the fan speed by pressing the Fan Speed Button until the light corresponding to the required fan speed lights up:

HIGH: The Fan operates at maximum to reach the required temperature as rapidly as possible.

MED: Reduces Fan noise level but still maintains a good level of comfort.

LOW: For quiet operation.

AUTO: The appliance automatically selects the most suitable fan speed in relation to the temperature set on the digital display.

DEHUMIDIFYING MODE

Ideal for reducing humidity in spring and autumn, during rainy spells or in damp rooms, etc.



Fig. 8

In dehumidifying mode, the appliance must have the same configuration as for the air conditioner mode, with the air exhaust hose fitted to the appliance to allow air to be discharged externally.

When the dehumidifying mode is selected, the light comes on and “dh” appears on the display. (See Fig. 8)

At the same time, the AUTO fan light comes on. In this mode, other fan speeds cannot be selected.

FAN MODE

Adjust fan speed by pressing the Fan Speed button as described for the cool mode.



Fig. 9

In this mode, AUTO fan cannot be selected.

The fan speed selected will show in the display. One row for Low, Two rows for medium and three rows for high. (See fig. 9)

HEAT MODE

Press the MODE button until the HEAT mode indicator light appears. Select the target temperature by pressing the **▲** or **▼** button until the corresponding value is displayed. (Temperature range is 55° to 81°F).

Then select the fan speed by pressing the Fan Speed Button until the light corresponding to the desired fan speed lights up: HIGH, MED, LOW, AUTO.

NOTE: At the beginning of this mode, you may have to wait a few seconds before the appliance starts to give out hot air.

In HEAT mode there will be water removed from the air and collected in the tank, when the tank is full, the appliance shuts down and “ft” (FULL TANK as mentioned in SELF-DIAGNOSIS appears on the display, the tank must be emptied, then the appliance will start up again. When operating in very cold rooms, the appliance defrosts automatically, intermittently interrupting normal operation. During the defrost operation “Lt” (LOW TEMPERATURE as mentioned in SELF-DIAGNOSIS) appears on the display. The fan will continue working for a few seconds to lower the interior temperature even after the appliance shuts off. In this mode, the fan may operate for short periods even though the set temperature has been reached.

SET UP & USE

CONTROL PANEL ON REMOTE CONTROL

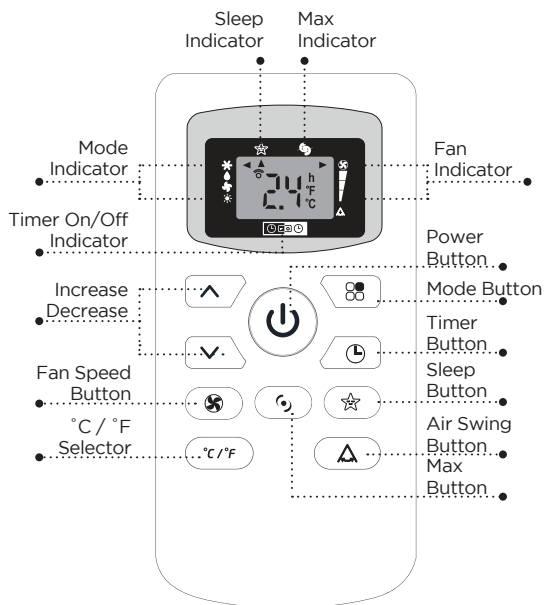

CORRECT USE

Point the remote control at the receiver on the appliance. The remote control must be no more than 7 meters away from the appliance (without obstacle between the remote control and the receiver).

The remote control must be handled with extreme care. Do not drop it or expose it to direct sun light or sources of heat.

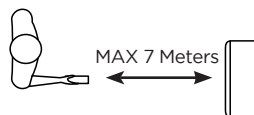

INSERTING OR REPLACING THE BATTERIES

Removing the cover on the rear of the remote control:

Insert two R03 "AAA" 1.5V batteries in the correct position (see instructions inside the battery compartment);

Replace the cover

If the remote control unit is replaced or disposed of, the batteries must be removed and discarded in accordance with current legislation as they are harmful to the environment.

SET UP & USE





OPERATING FROM THE REMOTE CONTROL

The first part of the controls on the remote control are the same as those on the control panel of the appliance.

You should therefore refer to the instructions in the chapter Operating from the Control Panel to turn the appliance on and select the operating mode (Cool, Dry, Fan, Heat) and the fan speed.

The following section describes the additional functions corresponding to the controls on the bottom part of the remote control.

COOLING MODE



- Press the  button to turn the appliance on.
- Press the MODE button () to select COOL.
- Set the temperature using the   button.
- To select fan speed, press the FAN SPEED button repeatedly until the required speed is selected (HIGH / MED / LOW / AUTO FAN).

NOTE: In COOLING mode, the appliance automatically removes excess moisture from the atmosphere.

DEHUM MODE

- Keep the windows and doors closed for an effective dehumidification.
- When used as dehumidifier only keep the air exhaust hose disconnected.
- Press the  button to turn the appliance on.
- Press the MODE button to select DRY. The fan speed will always be on FAN (Fan Speed Auto) and cannot be adjusted in DRY mode.

FAN MODE

- Press the  button to turn the appliance on.
- Press the MODE button to select FAN
- To select fan speed, press the FAN SPEED button () repeatedly until the required speed is selected (HIGH / MED / LOW) and AUTO FAN SPEED can not be selected.

HEAT MODE

- Press the  button to turn on the appliance.
- Press the MODE button to select HEAT mode.
- To select fan speed, press the FAN SPEED button repeatedly until the required speed is selected (HIGH/MED/LOW/AUTO FAN).

SET UP & USE

MAX FUNCTION

- Ideal for the summer to cool rooms rapidly.
- Activate by simply pressing the MAX button (Ⓞ).
- The appliance operates in cool mode at fan speed auto. While this function is selected, it is not possible to set the temperature or change fan speed.
- Display on the control panel:



It is at max function when the display is in constant motion (see above).

NOTE: MAX function button will not operate while the unit is in the HEAT MODE.

SLEEP OPERATION

The selected temperature will increase (cooling) or decrease (heating) by 1°F/1°C for the first 60 minutes. The temperature will then increase (cooling) by another 1°F/1°C after an additional 60 minutes. The temperature will then decrease (heating) by another 2°F/2°C after an additional 120 minutes. This sleep operation will be maintained for 6 hours before it returns to shutdown.

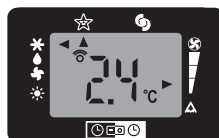

NOTE: · This feature is not available in FAN mode.

- This function is useful for the night as it gradually reduces operation of the appliance. To set this function correctly.
- Select the operating mode (COOL/DRY) as described above.
- Press the SLEEP button (☆) the appliance operates in the previously selected mode.

AIR SWING FUNCTION

- This function is useful for selecting the left/right swing of air circulation.
- To set this function correctly:
 - Select the operating mode (cool/dry/fan) as described above.
 - Press the “△” button. The appliance operates in the previously selected mode. The message “▶△” appears on the remote control to indicate swing is activated.
 - Press the swing button again, the message “▶” disappears to indicate swing is stopping.







SETTING THE TIMER





- This timer can be used to delay the appliance start up to shutdown, this avoids wasting electricity by optimizing operating periods.

SET UP & USE

PROGRAMMED SHUTDOWN

- With the appliance on, press the TIMER button, the TIMER is displayed under the .
- Set the time when you want the appliance to switch off using the   buttons (from 30 minutes to 24 hours).
- During the first ten hours you can select half intervals. For times longer than ten hours, one hour intervals can be selected.
- Press the TIMER button again to confirm the setting. The TIMER symbol light  on remote control panel will light up to indicate the timer is activated.
- At the end of the set time the appliance switches off automatically.
- To cancel the TIMER setting press the TIMER button again whenever during the set time.



PROGRAMMED START UP

- Turn on the appliance and set the working mode you desire.
- Press  button to switch into STANDBY.
- Press the TIMER button twice the time is displayed and  symbol.
- Set the time when you want the appliance to switch on using the   buttons (from 30 minutes to 24 hours).
- During the first ten hours you can select half intervals. For times longer than ten hours, one hour intervals can be selected.
- Press the TIMER button again to confirm the setting the TIMER symbol light  on control panel light up to indicate the timer is activated.
- At the end of the set time the appliance switches on automatically and operates in the same working mode as prior to switching into STANDBY, for example cooling mode, 25°C fan speed high.
- To cancel the TIMER setting press the TIMER button again whenever during the set time.

NOTE: A flashing green dot will appear on the bottom right of control panel LCD display when timer function is active.

SELF-DIAGNOSIS

The appliance has a self diagnosis system to identify a number of malfunctions. Error messages are displayed on the appliance display.

IF DISPLAYED,	WHAT SHOULD I DO?
 LOW TEMPERATURE (frost prevention)	The appliance is fitted with a frost protection device to avoid excessive formation of ice. The appliance starts up again automatically when the defrosting process is completed.
 PROBE FAILURE (sensor damaged)	If this is displayed, contact your local authorised service centre.
 FULL TANK (safely tank full)	Empty the internal safety tank following the instructions in the "End of season operations" paragraph.

SET UP & USE

WATER DRAINAGE METHOD

This air conditioner is equipped with the very latest MIST technology which means the water tank nearly never fills, hence water drainage will generally only be required at the end of the season (see START-END OF SEASON OPERATIONS in page 19. However the MIST technology does not operate when the unit is in HEAT mode. Thus the tank may still require emptying in HEAT mode.

NOTE: As a safety measure to positively prevent water spillage the air conditioner is equipped with a fail safe device if the water tank fills. The unit will completely stop, the control panel displays ft (FULL TANK) as mentioned on SELF DIAGNOSIS in page 17. The compressor and fan will not restart until the tank has been drained.

INTERMITTENT DRAINAGE (FIG. 10 AND FIG. 11)

- Turn the air conditioner off then drain the water tank by unplugging the drain cap and allowing the water to flow into a receptacle pan. Your pan may not hold the full contents of the water tank. A number of fills of your pan may be required.
- To insure all water has been removed tilt the unit by lifting it slightly upwards from the front until no more water drains from the outlet.
- Restart the air conditioner by pressing the power button. Ensure that the unit is in COOL or DRY mode. The compressor will start approximately 3 minutes after the unit is switched on.

Figure 10

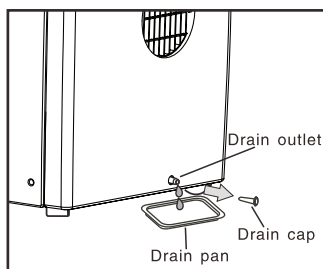
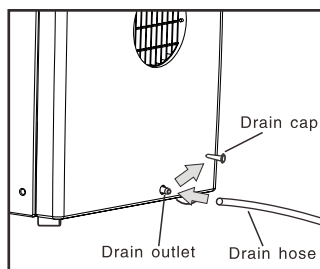

Figure 11



SET UP & USE

CONTINUOUS DRAINAGE (FIG. 12 AND FIG. 13)

When operating in HEAT mode, continuous drain method can also be used to avoid the trouble of manual drainage.

- Empty the water tank completely.
- Connect one end of the drain hose on the drain outlet and lead the other end to a permanent drain.
- Turn on the appliance and select HEAT mode.

When continuous drainage method adopted in HEAT mode the water removed from the air flows out through the drain hose continuously.

Note: Please be sure that the height of an section of the drain hose should not be higher than that of the drain outlet or the water tank may not be drained.

Figure 12

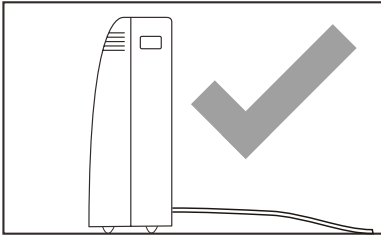
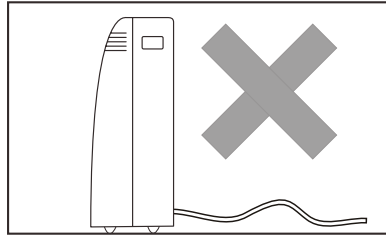



Figure 13



SET UP & USE

CLEANING

Before cleaning or maintenance, turn the appliance off by pressing the  button on the control panel or  button on the remote control. Wait for a few minutes then unplug from the electrical outlet.

CLEANING THE CABINET

You should clean the appliance with a slightly damp cloth then dry with a dry cloth.

- Never wash the air conditioner with water. It could be dangerous/
- Never use petrol, alcohol or solvents to clean the appliance.
- Never spray insecticide liquids or similar

CLEANING THE FILTERS

To keep your air conditioner working efficiently, you should clean the filters every week of operation.

The evaporator filter can be removed as shown in Fig. 14.

The condenser filter is two pieces.

STEP 1: Take out one filter as shown in Fig. 15

STEP 2: Take out other filter as shown in Fig. 16 and Fig. 17.

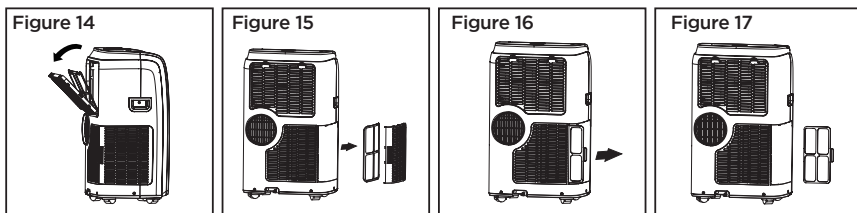

Use a vacuum cleaner to remove dust accumulations from the filters. If it is very dirty, immerse in warm water and rinse a number of times. The water should be luke warm. After washing, leave the filters to dry then re-insert.

START - END OF SEASON OPERATIONS

START OF SEASON CHECKS

Make sure the power cable and plug are undamaged. Follow the installation instructions precisely.

END OF SEASON OPERATIONS

To empty the internal circuit completely of water, remove the drain cap (Fig. 10 on page 18)

Run off all water left into basin. When all the water has been drained, put the cap back in place.

Clean the filter and dry thoroughly before putting back.

TROUBLESHOOTING & WARRANTY

BEFORE YOU CALL FOR SERVICE

IF THE AIR CONDITIONER FAILS TO OPERATE:

- A) Check to make sure that the air conditioner is plugged in securely. If it is not, remove the plug from the outlet, wait 10 seconds and plug it in again securely.
- B) Check for a blown circuit fuse or a tripped main circuit breaker. If these seem to be operating properly, test the outlet with another appliance.

IF NONE OF THE ABOVE SOLVES THE PROBLEM, CONTACT A QUALIFIED TECHNICIAN. DO NOT TRY TO ADJUST OR REPAIR THE AIR CONDITIONER YOURSELF.

CUSTOMER SERVICE

IMPORTANT

DO NOT RETURN THIS PRODUCT TO THE STORE

If you have a problem with this product, please contact the W Appliance Co. Customer Satisfaction Center at 844-299-0879.

**DATED PROOF OF PURCHASE, MODEL # AND SERIAL #
REQUIRED FOR WARRANTY SERVICE**

TROUBLESHOOTING & WARRANTY

Troubleshoot your problem by using the chart below. If the air conditioner still does not work properly, contact W Appliance Co. customer service center or the nearest authorized service center. Customers must never troubleshoot internal components.

TROUBLE	POSSIBLE CAUSE	POSSIBLE REMEDY
Unit does not start when pressing ON/OFF button	<ul style="list-style-type: none"> A. FT appears in the display window B. Room temperature is lower than set temperature (cooling mode) 	<ul style="list-style-type: none"> A. Drain the water in the bottom tray B. Reset the temperature
Not cool enough	<ul style="list-style-type: none"> A. The windows or doors in the room are not closed B. There are heat sources inside the room C. Exhaust air duct is not connected or blocked D. Temperature setting is too high E. Air filter is blocked by dust F. The unit will take approx 3 minutes of operation before cooling/heating occurs. 	<ul style="list-style-type: none"> A. Make sure all the windows and doors are closed B. Remove the heat sources if possible C. Connect the duct and make sure it can function properly D. Decrease the set temperature E. Clean the air filter F. A microprocessor control delays the compressor from operating until 3 mins have passed.
Noisy or vibration	<ul style="list-style-type: none"> A. The surface is not level or not flat enough 	<ul style="list-style-type: none"> A. Place the unit on a flat, level surface if possible
Gurgling sound	<ul style="list-style-type: none"> A. The sound comes from the flowing of the refrigerant inside the air-conditioner 	<ul style="list-style-type: none"> A. It is normal
Unit stops operating	<ul style="list-style-type: none"> A. LT appears in display window 	<ul style="list-style-type: none"> A. Unit is in defrost mode and will restart automatically once excess frost has been removed.

TROUBLESHOOTING & WARRANTY

LIMITED WARRANTY

Any repair, replacement, or warranty service, and all questions about this product should be directed to W Appliance Co. at **844-299-0879** from the USA or Puerto Rico.

W Appliance Co. warrants to the original purchaser that the product will be free from defects in material, parts and workmanship for the period designated for this product. The warranty commences the day the product is purchased and covers up to a period of **1 year (12 months) for labor/1 year (12 months) for parts (manufacturing defects only)/and a total of 5 years (60 months) for compressor part only.**

W Appliance Co. agrees that it will, at its option, replace the defective product with either a new or remanufactured unit equivalent to your original purchase during the warranty period.

Exclusions: This warranty does not apply to the below:

1. If the appearance or exterior of the product has been damaged or defaced, altered or modified in design or construction.
2. If the product original serial number has been altered or removed or cannot be readily determined.
3. If there is damaged due to power line surge, user damage to the AC power cord or connection to improper voltage source.
4. If damage is due to general misuse, accidents or acts of God.
5. If repair attempts are done by unauthorized service agents, use of parts other than genuine parts or parts obtained from persons other than authorized service companies.
6. On units that have been transferred from the original owner.
7. On products that have been purchased as refurbished, like new, second-hand, in a "As-Is" or "Final Sale" terms.
8. To products used in a commercial or rental setting.
9. To products used in settings other than ordinary household use or used other than in accordance with the provided instructions.
10. To damages for service calls for improper installations.
11. To glass parts and other accessory items that are included with the unit.
12. Transportation and shipping costs

associated with the replacement of the unit.

13. Food loss for loss due to product failure or delay in service, repair or replacement.
14. Service calls to instruct you how to use your product.
15. Service calls to repair or replace the house fuse, reset the circuit breaker or correct the wiring in the house.

REPAIR OR REPLACEMENT AS PROVIDED UNDER THIS WARRANTY IS THE EXCLUSIVE REMEDY OF THE CUSTOMER; W Appliance Co. SHALL NOT BE LIABLE FOR ANY INCIDENTAL OR CONSEQUENTIAL DAMAGES FOR BREACH OF ANY EXPRESS OR IMPLIED WARRANTY ON THIS PRODUCT, EXCEPT TO THE EXTENT PROHIBITED BY APPLICABLE LAW. ANY IMPLIED WARRANTY OF MERCHANTABILITY OF FITNESS FOR A PARTICULAR PURPOSE ON THIS PRODUCT IS LIMITED TO THE DURATION OF THE WARRANTY.

Some states do not allow the exclusion or limitations of incidental or consequential damages, or limitations on how long the warranty lasts. In these cases the above exclusions or limitations may not apply to you. This warranty gives you specific legal rights and you may also have other rights which vary from state to state.

Obtaining Service: To obtain service, product literature, supplies or accessories please call **844-299-0879** to create a ticket for exchange/repair. Please make sure to provide the date of purchase, model number and a brief description of the problem. Our customer service representative will contact you or send detailed return instructions.

W Appliance Co. does not warrant that the appliance will work properly in all environmental conditions, and makes no warranty and representation, either implied or expressed, with respect to the quality, performance, merchantability, or fitness for a particular purpose other than the purpose identified within this user's manual. W Appliance Co. has made every effort to ensure that this user's manual is accurate and disclaims liability for any inaccuracies or omissions that may have occurred. Information in this user's manual is subject to change without notice and does not represent a commitment on the part of W Appliance Co.. W Appliance Co. reserves the right to make improvements to this user's manual and/or to the products described in this user's manual at any time without notice. If you find information in this manual that is incorrect, misleading, or incomplete, please contact us at **844-299-0879**.

W Appliance Co.
New York, NY 10018

BLACK & DECKER, BLACK+DECKER, the BLACK & DECKER and BLACK+DECKER logos and product names and the orange and black color scheme are trademarks of The Black & Decker Corporation, used under license. All rights reserved.

Product in this box may differ slightly from that pictured. Does not affect function. Not all accessories shown in photography are included in this package.

Imported by W Appliance, Inc., 1356 Broadway, New York, NY 10018

Free Manuals Download Website

<http://myh66.com>

<http://usermanuals.us>

<http://www.somanuals.com>

<http://www.4manuals.cc>

<http://www.manual-lib.com>

<http://www.404manual.com>

<http://www.luxmanual.com>

<http://aubethermostatmanual.com>

Golf course search by state

<http://golfingnear.com>

Email search by domain

<http://emailbydomain.com>

Auto manuals search

<http://auto.somanuals.com>

TV manuals search

<http://tv.somanuals.com>