

Before you can use the machine, read this Quick Setup Guide for the correct setup and installation. To view the Quick Setup Guide in other languages, please visit <http://solutions.brother.com/>.

! IMPORTANT

DO NOT connect the interface cable yet.

1

Unpack the machine

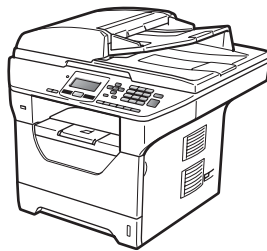

! WARNING

Plastic bags are used in the packaging of your machine. To avoid danger of suffocation, please keep these bags away from babies and children.

Note

USB cable

Please make sure you use a USB 2.0 cable (Type A/B) that is no longer than 2 metres.







Parallel cable

DO NOT use a parallel interface cable that is longer than 2 metres. Use a shielded interface cable that is IEEE 1284-compliant.

Network cable

Use a straight-through Category5 (or greater) twisted-pair cable for 10BASE-T or 100BASE-TX Fast Ethernet Network.

Symbols used in this guide

 WARNING	WARNINGS tell you what to do to prevent possible personal injury.
 CAUTION	CAUTIONS specify procedures you must follow or avoid to prevent possible minor injuries.
 IMPORTANT	IMPORTANT describe procedures you must follow or avoid to prevent possible machine problems or machine damage, or damage to other objects.
	Electrical Hazard icons alert you to a possible electrical shock.
	Hot Surface icons warn you not to touch machine parts that are hot.
 Note	Notes tell you how you should respond to a situation that may arise or give tips about how the current operation works with other features.
 User's Guide Software User's Guide Network User's Guide	Indicates reference to the User's Guide, Software User's Guide or Network User's Guide.

2 Install the drum unit and toner cartridge assembly

! IMPORTANT

DO NOT connect the interface cable yet.



a Remove the protective tape and film covering the scanner glass.

b Press the front cover release button and open the front cover ①.

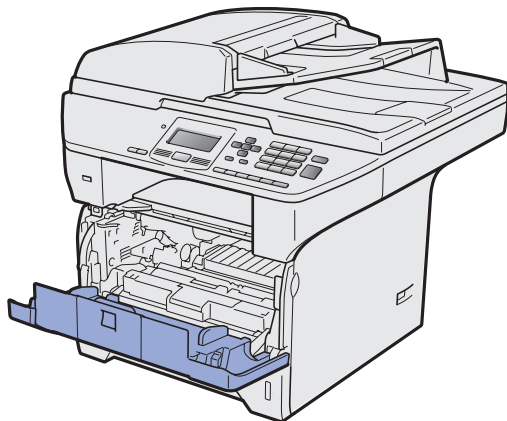
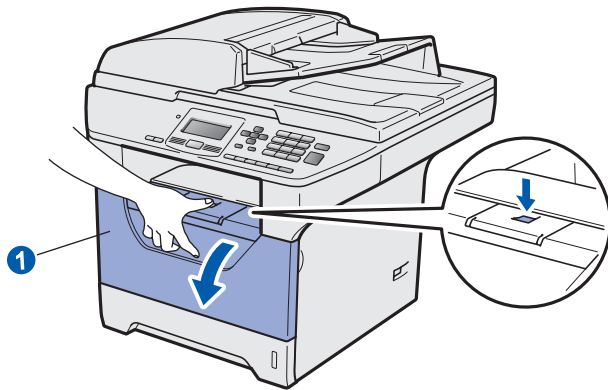

c Unpack the drum unit and toner cartridge assembly.

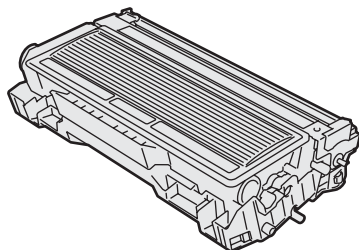

d Gently shake it from side to side several times to distribute the toner evenly inside the assembly.

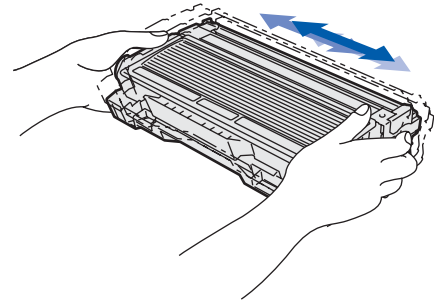

e Put the drum unit assembly into the machine until it clicks into place.

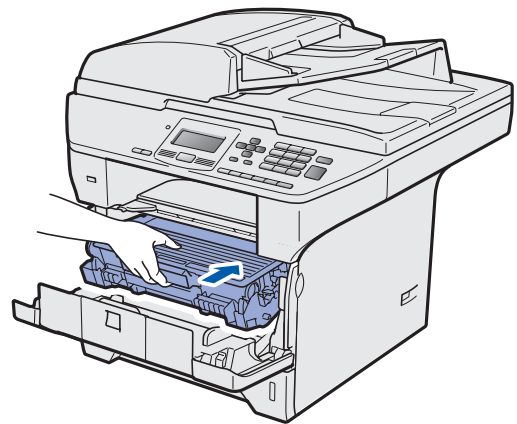

f Close the front cover of the machine.

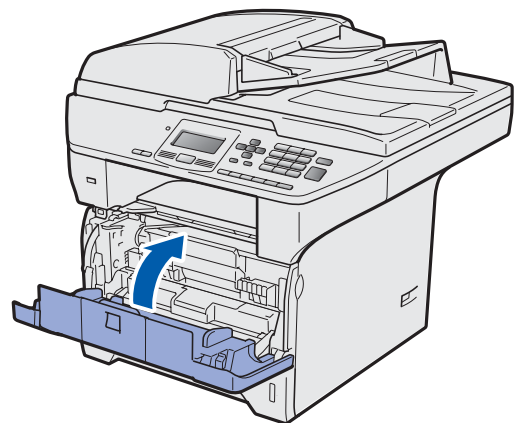

3 Load paper in the paper tray

- a** Pull the paper tray completely out of the machine.

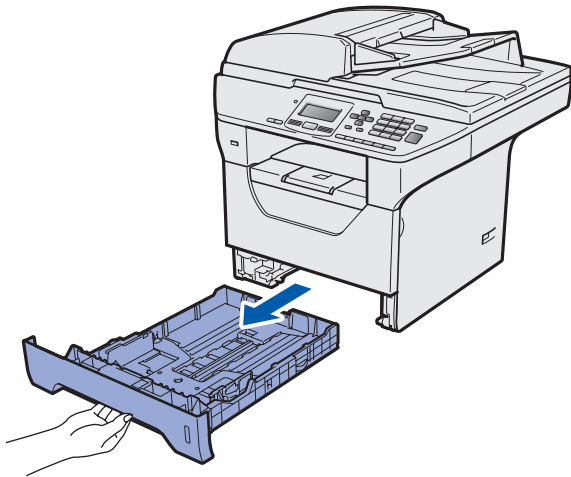

- b** While pressing the blue paper-guide release lever ①, slide the paper guides to fit the paper size you are loading in the tray. Make sure that the guides are firmly in the slots.

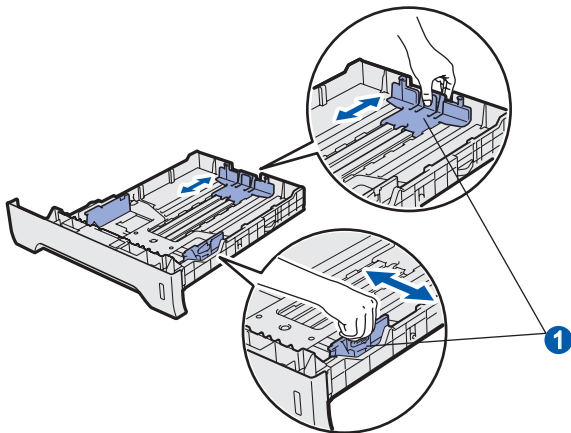

- c** Fan the stack of paper well to avoid paper jams and misfeeds.

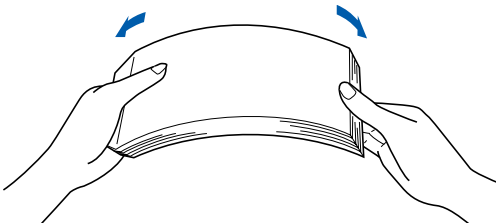

- d** Put paper in the tray, and make sure that the paper is below the maximum paper mark ①. The side to be printed on must be face down.

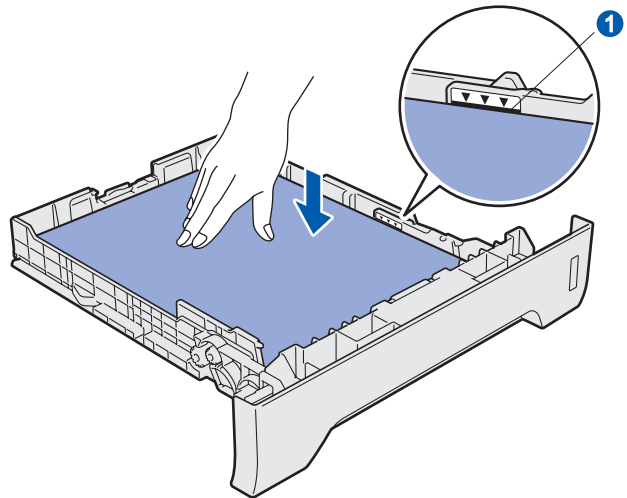

! IMPORTANT

Make sure the paper guides touch the sides of the paper so it will feed correctly.

- e** Put the paper tray firmly back in the machine. Make sure that it is completely inserted into the machine.
- f** Unfold the support flap ① to prevent paper from sliding off the face-down output tray.

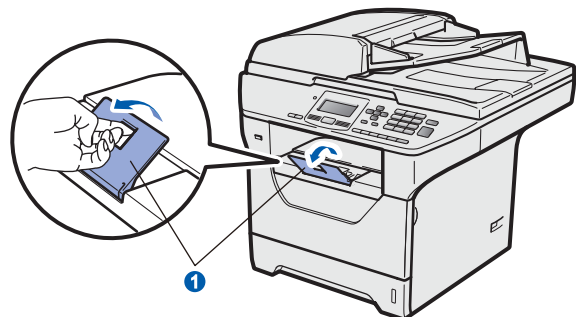

4 Attach the control panel cover

- a Open the document cover.
- b Choose your language and attach the control panel cover to the machine.

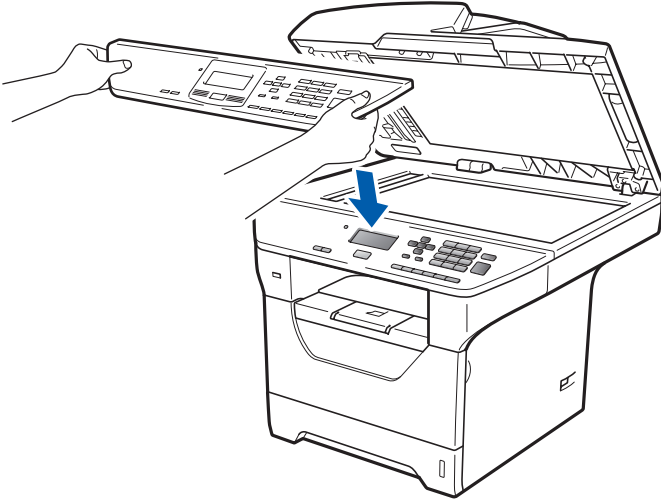

Note

If the control panel cover is not fitted correctly, the key operations will not work.

5 Release the scanner lock

Push the lever ① in the direction shown to unlock the scanner.
(The grey scanner lock lever is located at the back left side, under the document cover ②.)

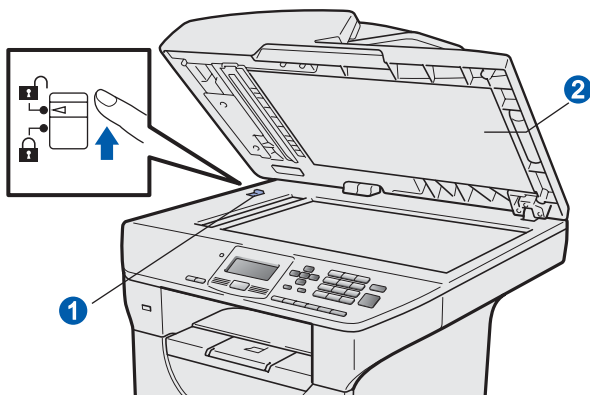

6 Connect the power cord

! IMPORTANT

DO NOT connect the interface cable yet.

- a Make sure that the machine power switch is off. Connect the AC power cord to the machine.

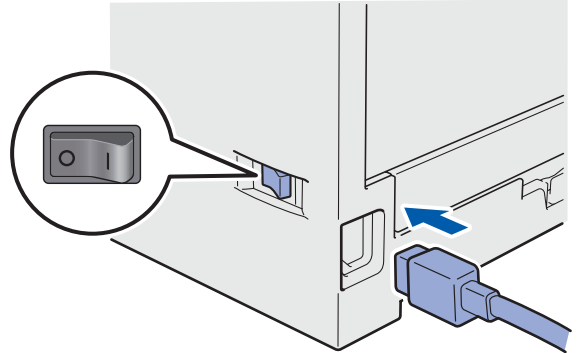

- b Plug the AC power cord into an AC outlet. Turn the power switch on.

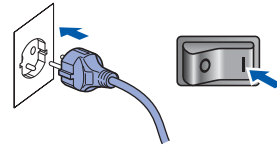

7 Choose your language

- a** After turning the power switch on, the LCD shows:

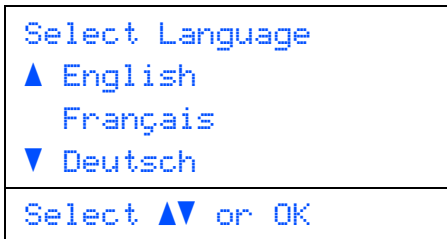

Press  or  to choose your language and press **OK**.

- b** The LCD prompts you to confirm your selection.

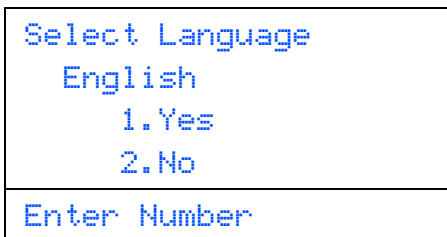

If the LCD shows the correct language, press **1**.

—OR—



Press **2** to go back to step **a** to choose the language again.



Note

- If *Scanner Locked* appears on the LCD, immediately release the scanner lock and press **Stop/Exit**. (See Release the scanner lock on page 4.)
- If you have set the wrong language, you can change the language from the control panel menu of the machine. (**Menu, 1, 0**)



8 Set the LCD contrast (If needed)

- a** Press **Menu**.
- b** Press **1**.
- c** Press **5**.
- d** Press  to increase the contrast.
—OR—
Press  to decrease the contrast.
Press **OK**.
- e** Press **Stop/Exit**.

9 Set the date and time

- a** Press **Menu**.
- b** Press **6**.
- c** Press **1**.
- d** Enter the last two digits of the year on the dial pad, and then press **OK**.
(e.g. Enter **0, 9** for 2009.)
- e** Enter the two digits for the month on the dial pad, and then press **OK**.
(e.g. Enter **0, 3** for March.)
- f** Enter the two digits for the day on the dial pad, and then press **OK**.
(e.g. Enter **2, 5**.)
- g** Enter the time in 24-hour format on the dial pad, and then press **OK**.
(e.g. Enter **1 5, 2 5** for 3:25 P.M.)
- h** Press **Stop/Exit**.

10 Automatic Daylight Savings Time

- a** Press **Menu**.
- b** Press **6**.
- c** Press **2**.
- d** Press  or  to choose On (or Off).
Press **OK**.
- e** Press **Stop/Exit**.

11

Choose your connection type

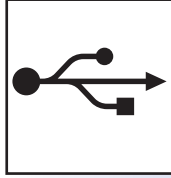
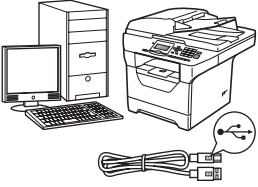

For USB Interface Users

Windows[®], go to page 8
Macintosh[®], go to page 10

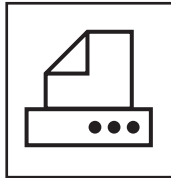
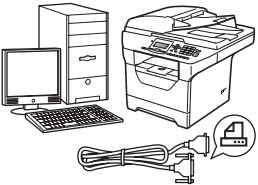

For Parallel interface cable

Windows[®], go to page 11

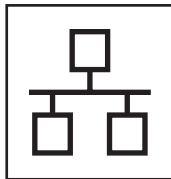
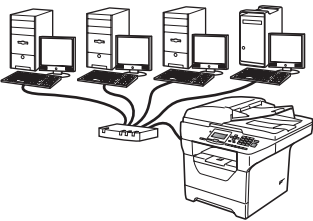

For Wired Network

Windows[®], go to page 13
Macintosh[®], go to page 15

For Windows Server[®] 2003/ 2008, see the *Network User's Guide* on the CD-ROM.

USB	Windows [®]
	Macintosh [®]
Parallel	Windows [®]
Wired Network	Windows [®]
	Macintosh [®]



For USB Interface Users (Windows® 2000 Professional/XP/XP Professional x64 Edition/ Windows Vista®)

12 Before you install

- a** Make sure that your computer is ON and you are logged on with Administrator rights.
- b** Turn off and unplug the machine from the AC outlet and disconnect it from your computer, if you already connected an interface cable.

13 Install MFL-Pro Suite

- a** Put the supplied CD-ROM into your CD-ROM drive. If the model name screen appears, choose your machine. If the language screen appears, choose your language.

Note

*If the Brother screen does not appear automatically, go to **My Computer (Computer)**, double-click the CD-ROM icon, and then double-click **Start.exe**.*

- b** The CD-ROM main menu will appear. Click **Initial Installation**.
- c** Click **Install MFL-Pro Suite**.
- d** When the ScanSoft™ PaperPort™ 11SE **License Agreement** window appears, click **Yes** if you agree to the Software **License Agreement**.
- e** The installation of ScanSoft™ PaperPort™ 11SE will automatically start and is followed by the installation of MFL-Pro Suite.
- f** When the Brother MFL-Pro Suite Software **License Agreement** window appears, click **Yes** if you agree to the Software **License Agreement**.
- g** Choose **Local Connection**, and then click **Next**. The installation continues.
- h** If you do not want to monitor the machine status and error notifications from your computer, uncheck **Enable Status Monitor** and then click **Next**.

- i** When this screen appears, go to the next step.

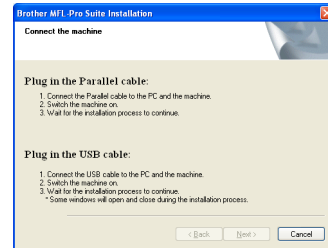

14 Connect the USB cable

- a** Remove the label covering the USB interface connector.

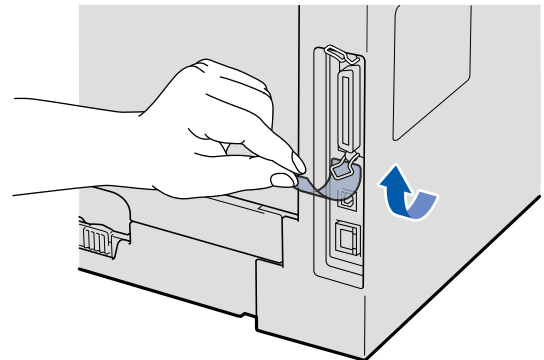

- b** Connect the USB cable to the USB connector on the machine marked with the  symbol. Then connect the cable to your computer.

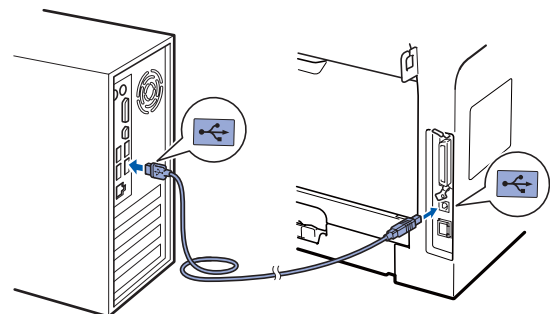



15

Connect the power cord

- a Plug the AC power cord into an AC outlet. Turn the power switch on.
The installation will continue automatically.
The installation screens appear one after another.

! IMPORTANT

DO NOT cancel any of the screens during the installation. It may take a few seconds for all screens to appear.

- b When the **On-Line Registration** screen is displayed, make your selection and follow the on-screen instructions. Once you have completed the registration process, close your web browser to return to this window. Then click **Next**.

16

Finish and restart

- a Click **Finish** to restart your computer. After restarting the computer, you must be logged on with Administrator rights.
- b In the **Check for Firmware Updates** screen, choose the firmware update setting you want and click **OK**. If you disabled the Status Monitor setting in step **h** the screen will not appear.

Note

Internet access is required for the firmware upgrade.

Finish

The installation is now complete.

Note

XML Paper Specification Printer Driver
The XML Paper Specification Printer Driver is the most suitable driver when printing from the applications that use the XML Paper Specification documents. Please download the latest driver by accessing the Brother Solutions Center at <http://solutions.brother.com/>.



For USB Interface Users (Mac OS® X 10.3.9 or greater)

12 Before you install

- a** Make sure your machine is connected to the power and your Macintosh® is ON. You must be logged on with Administrator rights.

13 Connect the USB cable

! IMPORTANT

- **DO NOT** connect the machine to a USB port on a keyboard or a non-powered USB hub.
- **Connect the machine directly to your Macintosh®.**

- a** Remove the label covering the USB interface connector.

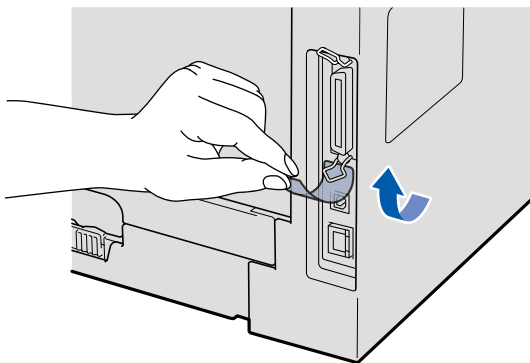

- b** Connect the USB cable to the USB connector on the machine marked with the  symbol. Then connect the cable to your computer.

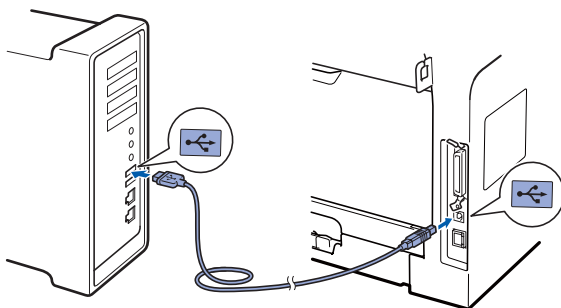

14 Install MFL-Pro Suite

- a** Put the supplied CD-ROM into your CD-ROM drive.
- b** Double-click **Start Here OSX** to install.
- c** The Brother software will search for the Brother device. During this time the following screen will appear.

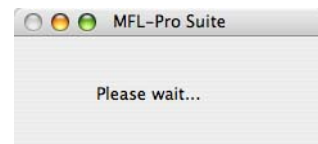

- d** Choose the machine from the list, and then click **OK**.
- e** When this screen appears, click **OK**.

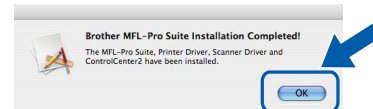

- OK!** The installation of MFL-Pro Suite is now complete. Go to step 15 on page 10.

15 Install Presto! PageManager

When Presto! PageManager is installed OCR capability is added to Brother ControlCenter2. You can easily scan, share and organize photos and documents using Presto! PageManager.

- a** Double-click **Presto! PageManager** and follow the on-screen instructions.

Finish The installation is now complete.



For Parallel Interface Users (Windows® 2000 Professional/XP/XP Professional x64 Edition)

12 Before you install

- a** Make sure that your computer is ON and you are logged on with Administrator rights.
- b** Turn off and unplug the machine from the AC outlet and disconnect it from your computer, if you already connected an interface cable.

13 Install MFL-Pro Suite

- a** Put the supplied CD-ROM into your CD-ROM drive. If the model name screen appears, choose your machine. If the language screen appears, choose your language.



Note

If the Brother screen does not appear automatically, go to **My Computer (Computer)**, double-click the CD-ROM icon, and then double-click **Start.exe**.

- b** The CD-ROM main menu will appear. Click **Initial Installation**.
- c** Click **Install MFL-Pro Suite**.
- d** When the ScanSoft™ PaperPort™ 11SE **License Agreement** window appears, click **Yes** if you agree to the Software **License Agreement**.
- e** The installation of ScanSoft™ PaperPort™ 11SE will automatically start and is followed by the installation of MFL-Pro Suite.
- f** When the Brother MFL-Pro Suite Software **License Agreement** window appears, click **Yes** if you agree to the Software **License Agreement**.
- g** Choose **Local Connection**, and then click **Next**. The installation continues.

- h** If you do not want to monitor the machine status and error notifications from your computer, uncheck **Enable Status Monitor** and then click **Next**.

- i** When this screen appears, go to the next step.

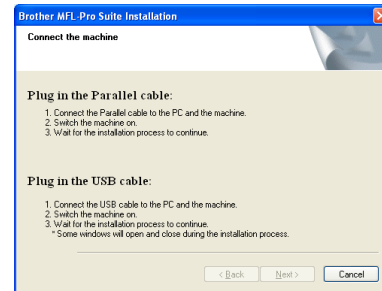

14 Connect the Parallel cable

! IMPORTANT

Connect the machine directly to your computer.

- a** Connect the Parallel interface cable to your computer, and then connect it to the machine.

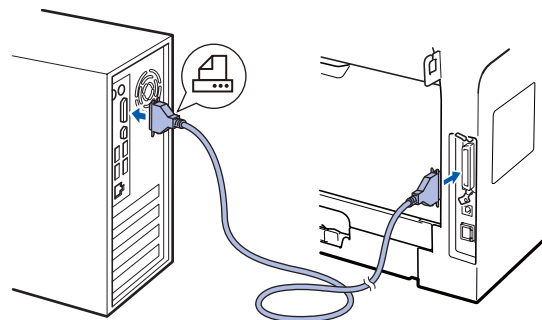



15 Connect the power cord

- a** Plug the AC power cord into an AC outlet. Turn the power switch on.
The installation will continue automatically.
The installation screens appear one after another.
- b** Do one of the following:
 - For Windows® 2000 Professional users, click **Next**.

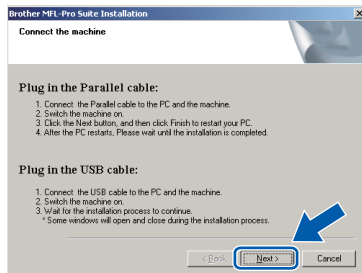

Note

If this screen appears, click **OK**.



- For Windows® XP/XP Professional x64 Edition users, wait for a while since the installation of the Brother drivers will automatically start. The screens appear one after another.

! IMPORTANT

DO NOT cancel any of the screens during the installation. It may take a few seconds for all screens to appear.

- c** When the **On-Line Registration** screen is displayed, make your selection and follow the on-screen instructions. Once you have completed the registration process, close your web browser to return to this window. Then click **Next**.

16 Finish and restart

- a** Click **Finish** to restart your computer. After restarting the computer, you must be logged on with Administrator rights.
- b** In the **Check for Firmware Updates** screen, choose the firmware update setting you want and click **OK**. If you disabled the Status Monitor setting in step **h** the screen will not appear.

Note

Internet access is required for the firmware upgrade.

Finish

The installation is now complete.

Note

XML Paper Specification Printer Driver

The XML Paper Specification Printer Driver is the most suitable driver when printing from the applications that use the XML Paper Specification documents. Please download the latest driver by accessing the Brother Solutions Center at <http://solutions.brother.com/>.



For Wired Network Interface Users (Windows® 2000 Professional/XP/XP Professional x64 Edition/ Windows Vista®)

12 Before you install

- a** Make sure that your computer is ON and you are logged on with Administrator rights.

! IMPORTANT

Disable all personal firewall software (other than Windows® Firewall), anti-spyware or antivirus applications for the duration of the installation.

- b** Unplug the machine from the AC outlet.

13 Connect the network cable

- a** Connect the network interface cable to the LAN connector marked with a  symbol and then connect it to a free port on your hub.

14 Connect the power cord

- a** Plug the AC power cord into an AC outlet. Turn the power switch on.

15 Install MFL-Pro Suite

- a** Put the supplied CD-ROM into your CD-ROM drive. If the model name screen appears, choose your machine. If the language screen appears, choose your language.



Note

*If the Brother screen does not appear automatically, go to **My Computer (Computer)**, double-click the CD-ROM icon, and then double-click **Start.exe**.*

- b** The CD-ROM main menu will appear. Click **Initial Installation**.
- c** Click **Install MFL-Pro Suite**.
- d** When the ScanSoft™ PaperPort™ 11SE **License Agreement** window appears, click **Yes** if you agree to the Software **License Agreement**.
- e** The installation of ScanSoft™ PaperPort™ 11SE will automatically start and is followed by the installation of MFL-Pro Suite.
- f** When the Brother MFL-Pro Suite Software **License Agreement** window appears, click **Yes** if you agree to the Software **License Agreement**.
- g** Choose **Network Connection**, and then click **Next**.
- h** For Windows® XP SP2/XP Professional x64 Edition/ Windows Vista® users, when this screen appears, choose **Change the Firewall port settings to enable network connection and continue with the installation. (Recommended)** and click **Next**.

If you are not using the Windows® Firewall, see the *User's Guide* for your software for information on how to add the following network ports.

- For network scanning, add UDP port 54925.
- If you still have trouble with your network connection, add UDP port 137.



- i** If the machine is configured for your network, choose the machine from the list, and then click **Next**.

 **Note**

- If your machine is not found over the network, following screen will appear.



Confirm your network setting by following the on-screen instructions.

- If the machine is not yet configured for use on your network, the following screen appears.



Click **OK** and then **Configure IP Address**. Enter an IP address for your machine that is suitable for your network by following the on-screen instructions.

- j** If you do not want to monitor the machine status and error notifications from your computer, uncheck **Enable Status Monitor** and then click **Next**.

- k** The installation of the Brother drivers will automatically start. The installation screens appear one after another.

IMPORTANT

DO NOT cancel any of the screens during the installation. It may take a few seconds for all screens to appear.

- l** When the **On-Line Registration** screen is displayed, make your selection and follow the on-screen instructions. Once you have completed the registration process, close your web browser to return to this window. Then click **Next**.

16

Finish and restart

- a** Click **Finish** to restart your computer. After restarting the computer, you must be logged on with Administrator rights.

- b** In the **Check for Firmware Updates** screen, choose the firmware update setting you want and click **OK**. If you disabled the Status Monitor setting in step **j** the screen will not appear.

 **Note**

Internet access is required for the firmware upgrade.

Finish

The installation is now complete.

 **Note**

XML Paper Specification Printer Driver

The XML Paper Specification Printer Driver is the most suitable driver when printing from the applications that use the XML Paper Specification documents. Please download the latest driver by accessing the Brother Solutions Center at <http://solutions.brother.com/>.



For Wired Network Interface Users (Mac OS® X 10.3.9 or greater)

12 Before you install

- a Make sure your machine is connected to the power and your Macintosh® is ON. You must be logged on with Administrator rights.

13 Connect the network cable

- a Connect the network interface cable to the LAN connector marked with a  symbol and then connect it to a free port on your hub.

14 Install MFL-Pro Suite

- a Put the supplied CD-ROM into your CD-ROM drive.
- b Double-click **Start Here OSX** to install.
- c The Brother software will search for the Brother device. During this time the following screen will appear.

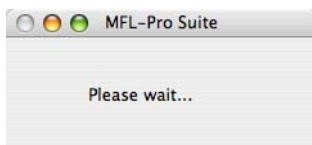

- d If the machine is configured for your network, choose the machine from the list, and then click OK.

Note

- If your machine is not found over the network, confirm your network setting.
- If this screen appears click **OK**.



- Enter a name for your Macintosh® in **Display Name** up to 15 characters long and click **OK**. Go to e.

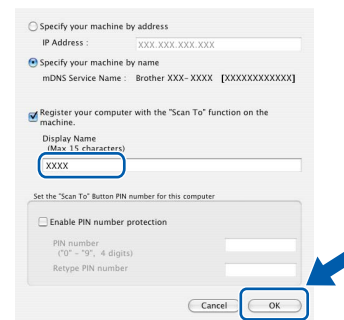

- If you want to use the machine's **Scan** key to scan over the network, you must check the **Register your computer with the "Scan To" function on the machine box**.
- The name you enter will appear on the machine's LCD when you press  and choose a scan option. (For more information, see *Network Scanning in the Software User's Guide on the CD-ROM*.)

- e When this screen appears, click **OK**.

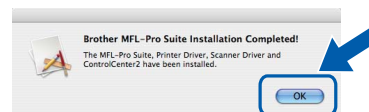

- OK!** The installation of MFL-Pro Suite is now complete. Go to step 15 on page 16.

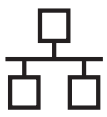

15 Install Presto! PageManager

When Presto! PageManager is installed OCR capability is added to Brother ControlCenter2. You can easily scan, share and organize photos and documents using Presto! PageManager.

- a** Double-click **Presto! PageManager** and follow the on-screen instructions.

Finish

The installation is now complete.

Other Information

To use the machine safely

Please keep these instructions for later reference and read them before attempting any maintenance.

⚠ WARNING



There are high voltage electrodes inside the machine. Before you clean the inside of the machine, make sure you have unplugged the power cord from the electrical socket. Doing this will prevent an electrical shock.

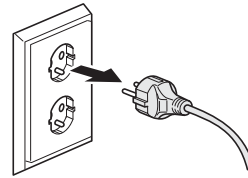

DO NOT handle the plug with wet hands. Doing this might cause an electrical shock. Always make sure the plug is fully inserted.

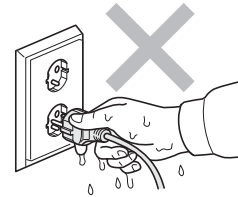

This product must be installed near an electrical socket that is easily accessible. In case of an emergency, you must unplug the power cord from the electrical socket to shut off the power completely.

DO NOT use flammable substances, any type of spray or any organic solvent/liquids contains alcohol or ammonia to clean the inside or outside of the machine. Doing this may cause a fire or electrical shock. Refer to *Routine maintenance* in the *User's Guide* for how to clean the machine.



DO NOT use a vacuum cleaner to clean up scattered toner. Doing this might cause the toner dust to ignite inside the vacuum cleaner, potentially starting a fire. Please carefully clean the toner dust with a dry, lint-free soft cloth and dispose of it according to local regulations.

⚠ CAUTION



After you have just used the machine, some internal parts of the machine will be extremely hot. When you open the front or back cover of the machine, DO NOT touch the shaded parts shown in the illustrations.

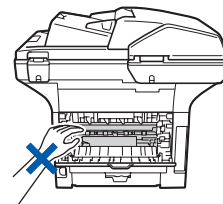
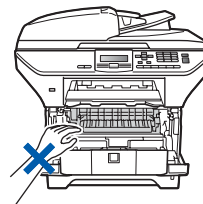

To prevent injuries, be careful not to put your hands on the edge of the machine under the document cover as shown in the illustration.



Other Information

⚠ CAUTION

To prevent injuries, be careful not to put your fingers in the areas shown in the illustrations.

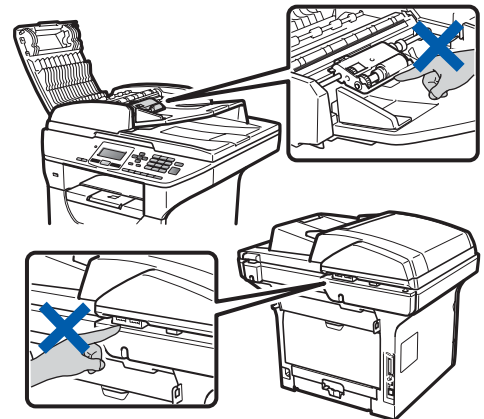

When you move the machine, grasp the side handholds that are under the scanner. **DO NOT** carry the machine by holding it at the bottom.

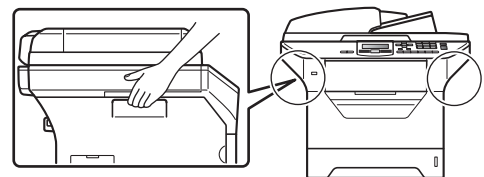

! IMPORTANT

The fuser unit is marked with a Caution label. Please **DO NOT** remove or damage the label.

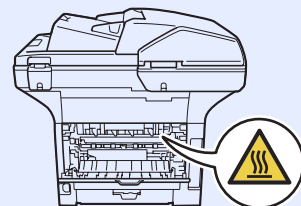

Note

Keep a minimum gap around the machine as shown in the illustration.

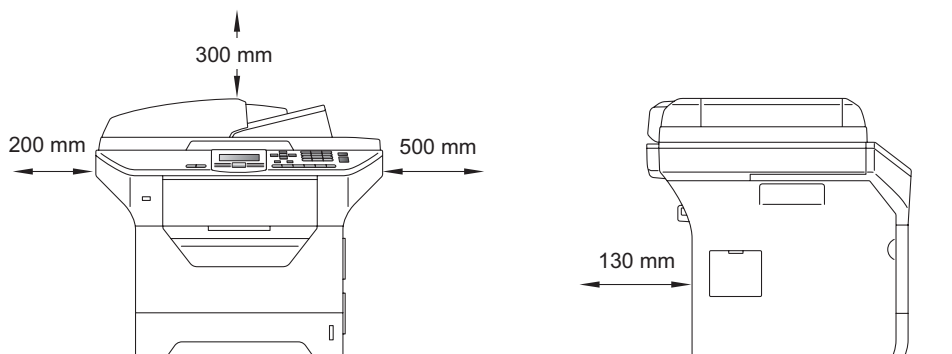

Regulations

EC Declaration of Conformity



EC Declaration of Conformity

Manufacturer

Brother Industries Ltd.,
15-1, Naeshiro-cho, Mizuho-ku, Nagoya 467-8561, Japan

Plant

Brother Technology (Shenzhen) Ltd.,
NO6 Gold Garden Ind. Nanling Buji, Longgang, Shenzhen, China

Herewith declare that:

Products description : Laser Printer
Product Name : DCP-8085DN

is in conformity with provisions of the Directives applied : Low Voltage Directive 2006/95/EC and the Electromagnetic Compatibility Directive 2004/108/EC.

Standards applied :

Harmonized : Safety EN60950-1:2006

EMC EN55022:2006 Class B
EN55024:1998 + A1:2001 + A2:2003
EN61000-3-2:2006
EN61000-3-3:1995 + A1:2001 + A2:2005

Year in which CE marking was first affixed : 2008

Issued by : Brother Industries, Ltd.

Date : 30th September, 2008

Place : Nagoya, Japan

Signature :

Junji Shiota
General Manager
Quality Management Dept.

IEC60825-1+A2:2001 Specification

This machine is a Class 1 laser product as defined in IEC60825-1+A2:2001 specifications. The label shown below is attached in countries where required.



This machine has a Class 3B Laser Diode which emits invisible laser radiation in the Scanner Unit. The Scanner Unit should not be opened under any circumstances.

Internal laser radiation

Wave length: 770 - 810 nm

Output: 5 mW max.

Laser Class: Class 3B

WARNING

Use of controls, adjustments or performance of procedures other than those specified in this manual may result in hazardous radiation exposure.

Disconnect device

This product must be installed near an electrical socket that is easily accessible. In case of emergencies, you must disconnect the power cord from the electrical socket to shut off power completely.

LAN connection

CAUTION

DO NOT connect this product to a LAN connection that is subject to over-voltages.

Radio interference

This product complies with EN55022 (CISPR Publication 22)/Class B.

EU Directive 2002/96/EC and EN50419



European Union only

This equipment is marked with the above recycling symbol. It means that at the end of the life of the equipment, you must dispose of it separately at an appropriate collection point, and not place it in the normal domestic unsorted waste stream. This will benefit the environment for all. (European Union only)

EU Directive 2006/66/EC - Removing or Replacing the Battery

This product incorporates a battery that is designed to last for the lifetime of the product. It is not to be replaced by the user. It should be removed as part of the machine recycling process at the end of life and appropriate precautions taken by the recycler.

International ENERGY STAR® Compliance Statement

The purpose of the International ENERGY STAR® Program is to promote the development and popularization of energy-efficient office equipment. As an ENERGY STAR® Partner, Brother Industries, Ltd. has determined that this product meets the ENERGY STAR® guidelines for energy efficiency.



Options and Consumables

Options

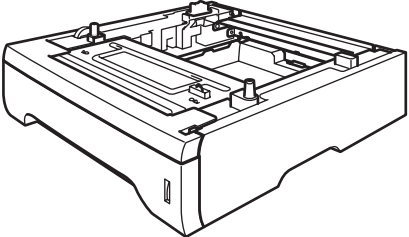
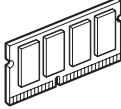
Lower Tray Unit	SO-DIMM Memory
LT-5300	
 <p data-bbox="100 611 671 734">Second lower paper tray unit can hold up to 250 sheets of paper. When the tray is installed, the machine expands total input capacity up to 550 sheets.</p>	 <p data-bbox="746 611 1366 674">You can expand the memory by installing a (144-pin SO-DIMM) memory module.</p>

For more details about the optional Lower Tray Unit and compatible SO-DIMM Memory please see the *User's Guide* or visit <http://solutions.brother.com/>.

Replacement consumables

When the time comes to replace consumable items, an error message will be indicated on the LCD. For more information about the consumables for your machine, visit <http://www.brother.com/original/> or contact your local Brother re-seller.

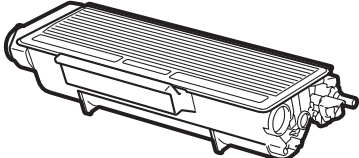
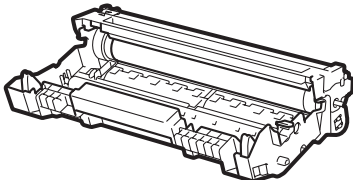
Toner cartridge	Drum unit
TN-3230/TN-3280	DR-3200
	

Trademarks

The Brother logo is a registered trademark of Brother Industries, Ltd.

Brother is a registered trademark of Brother Industries, Ltd.

Multi-Function Link is a registered trademark of Brother International Corporation.

Windows Vista is either a registered trademark or a trademark of Microsoft Corporation in the United States and other countries.

Microsoft, Windows and Windows Server and Internet Explorer are registered trademarks of Microsoft Corporation in the United States and/or other countries.

Apple, Macintosh, Safari and TrueType are trademarks of Apple Inc., registered in the United States and other countries.

Nuance, the Nuance logo, PaperPort and ScanSoft are trademarks or registered trademarks of Nuance Communications, Inc. or its affiliates in the United States and/or other countries.

Each company whose software title is mentioned in this manual has a Software License Agreement specific to its proprietary programs.

All other brand and product names mentioned in this manual are trademarks or registered trademarks of their respective companies.

Compilation and Publication

Under the supervision of Brother Industries, Ltd., this manual has been compiled and published, covering the latest product descriptions and specifications.

The contents of this manual and the specifications of this product are subject to change without notice.

Brother reserves the right to make changes without notice in the specifications and materials contained herein and shall not be responsible for any damages (including consequential) caused by reliance on the materials presented, including but not limited to typographical and other errors relating to the publication.

Copyright and License

©2009 Brother Industries, Ltd.

This product includes software developed by the following vendors:

©1983-1998 PACIFIC SOFTWARES, INC.

This product includes the "KASAGO TCP/IP" software developed by ELMIC WESCOM, Inc.

©2009 Devicescape Software, Inc.

Free Manuals Download Website

<http://myh66.com>

<http://usermanuals.us>

<http://www.somanuals.com>

<http://www.4manuals.cc>

<http://www.manual-lib.com>

<http://www.404manual.com>

<http://www.luxmanual.com>

<http://aubethermostatmanual.com>

Golf course search by state

<http://golfingnear.com>

Email search by domain

<http://emailbydomain.com>

Auto manuals search

<http://auto.somanuals.com>

TV manuals search

<http://tv.somanuals.com>