



Bellavista B36X shown with flush panels, finishing trim and brick panels.

Practical Beauty

Bellavista, meaning panorama or beautiful view in Italian, is exactly what you will get with a 641 square inch viewing area with a full, hand crafted log set and stunning fire. This versatile fireplace can be installed almost anywhere in your home to provide up to 18,500 BTU of consistent, controllable heat, operating even during power outages. Enjoy multiple styling options: choose sleek flush panels or traditional full screen doors, one of 3 realistic brick styles, or stainless steel inset panels to match your home décor.

Specifications	Natural Gas	Propane
Input (BTU)	18,500	17,500
Turn Down to (BTU)	12,500	14,500
EnerGuide Rating*	61.60%	64.32%
Efficiency (steady state)	69%	70%

* for Canada only

Unit Dimensions	
Width	36"
Height	35-1/4"
Depth	17-5/16"

design choices



Louvers

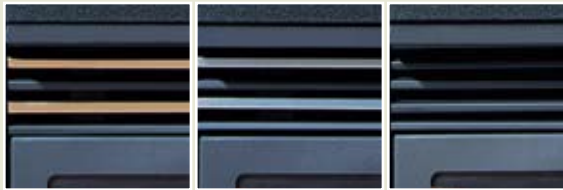

Gold* Brushed Steel Black

Arched Screen Doors



Black Midnight Brown Midnight Gray

Brick Panels

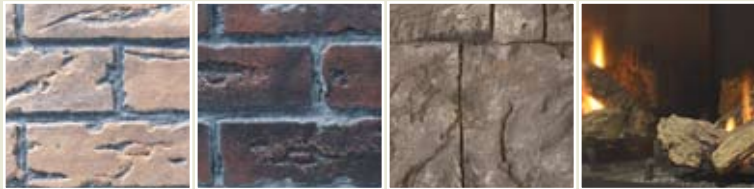

Standard - Rustic Brown Standard - Old Town Red Castle Stone Brushed Stainless Steel

* 24 k gold plated



Standard Features

- Beautiful fire with glowing logs and platinum embers
- Black vermiculite floor
- Black flush panels
- 641 sq. in. viewing area
- Flame height adjustment control
- Flush front with tempered glass
- Standing pilot
- Top or rear vent for versatile installations
- Wall mounted on/off switch

Optional Features

- Louvers
- Finishing trim
- Arch full screen doors
- Brick panels
- Variable speed blower
- Proflame Remote Control
- LP conversion kit
- Vertical or horizontal vent terminations
- Heat Wave™ Power Duct Kit
- AstroCap™ Venting System

specifications

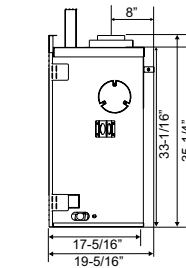
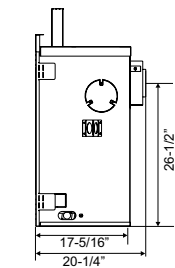
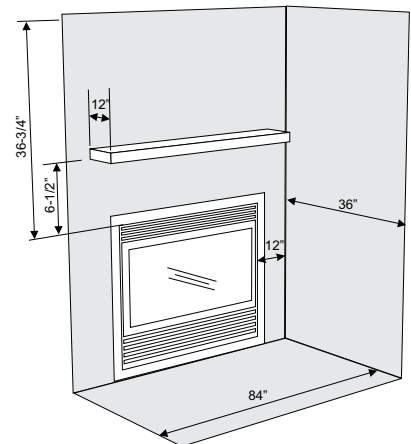
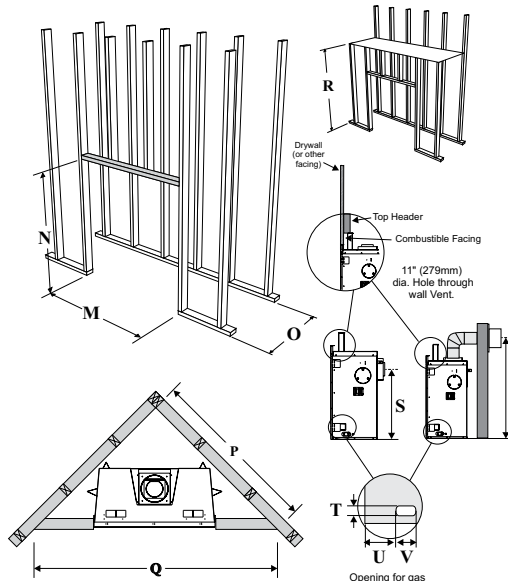
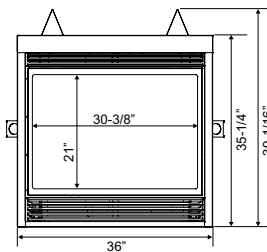
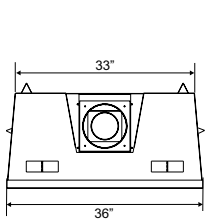

Framing Dimensions			
M	36-1/4"	R (rear vent)	39-3/8"
N	39-3/8"	(top vent)	50-1/2"
O (rear vent)	20-3/4"	S (rear vent)	26-1/2"
(top vent)	19-1/2"	(top vent)	42-1/8"
P (rear vent)	53"	T	1-1/2"
(top vent)	48-5/8"	U	4-1/8"
Q (rear vent)	75"	V	3-1/4"
(top vent)	68-3/4"		

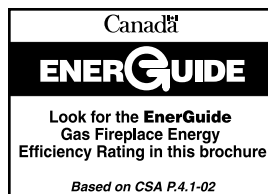

your regency dealer

Free Manuals Download Website

<http://myh66.com>

<http://usermanuals.us>

<http://www.somanuals.com>

<http://www.4manuals.cc>

<http://www.manual-lib.com>

<http://www.404manual.com>

<http://www.luxmanual.com>

<http://aubethermostatmanual.com>

Golf course search by state

<http://golfingnear.com>

Email search by domain

<http://emailbydomain.com>

Auto manuals search

<http://auto.somanuals.com>

TV manuals search

<http://tv.somanuals.com>