

3:1

3:1 pitch

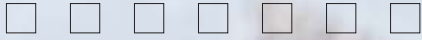

RENZ RING WIRE® wire comb binding

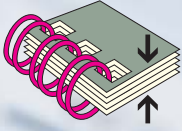

max. 12 mm [1/2"]

up to 12 mm [1/2"] book thickness
binds up to 120 sheets

RENZ®

BINDING AND LAMINATING SYSTEMS

RW
SRW
SRW Comfort
ERW

RENZ®
SRW comfort

800-658-8788

www.abcoffice.com

OPEN HERE



3:1 pitch

smooth work flow
from top to bottom

environmentally friendly and contemporary

opens flat and stays flat – 360° rotation
for professional presentation of documents

secure and durable binding
easy insertion of the pages onto the open wire comb

up to 12 mm [1/2"] book thickness



RW

The basic model for manual punching and binding of all formats up to A4 [12"] [3:1 pitch] [US model 11"]. Punching and binding are done with a minimum of effort due to the logically separated functions of the convenient two-lever system and the integrated binding part. Punches up to 25 sheets [2.5 mm / 0.1"] and binds up to 120 sheets.



SRW

Ring Wire binding machine [3:1] with additional features: 38 punch pins that can be individually disengaged and adjustable margin control for perfect format adjustment up to 34 cm [13.5"]. Punches up to 25 sheets [5 mm / 0.1"] and binds up to 120 sheets. [other features same as model RW]

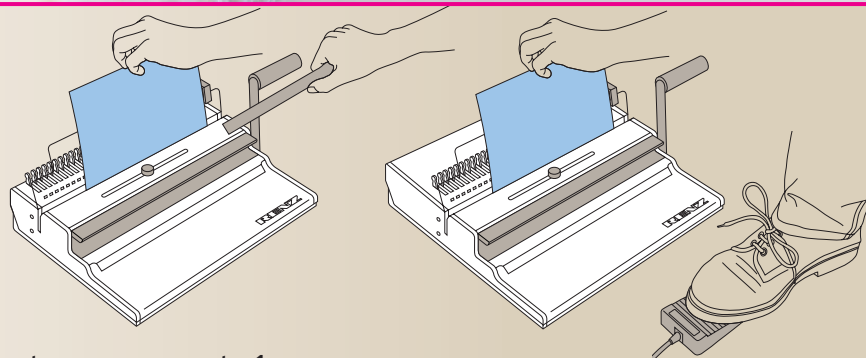
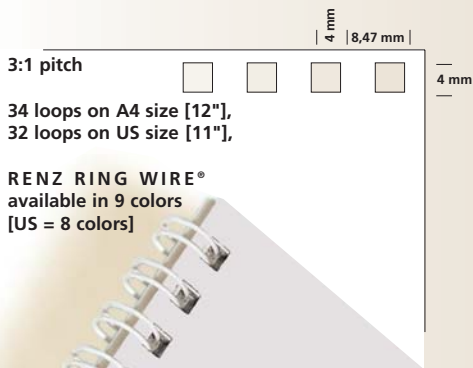

Easy to use:

step 1

The paper drops vertically into the punching slot. Specially hardened punching stamps will punch paper pads up to 2.5 mm [0.1"] thick [2.0 mm / 0.08" for the SRW Comfort] and provide

accurate punching results with minimal effort [manual versions]. With electrical machines, punching is done by pressing the foot pedal.

800-658-8788

www.abcoffice.com



SRW Comfort

The basic electrical model for Ring Wire comb binding [3:1] – comfortable electric punching and manual binding. An economical solution for small to medium quantities. The motor runs only when the foot pedal is pressed so that it uses electricity only during the punching cycle. [otherwise as model SRW].



ERW

Self-contained Ring Wire machine [3:1] with professional punching process. The powerful motor is fan-cooled and is the professional solution for larger quantities. Fast punching cycle takes only approx. 1 second. [otherwise as model SRW].

integrated scale for easy determination of correct wire diameter

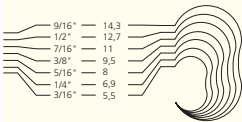

Turn the adjustment knob to select margin. For thicker books, a larger margin is recommended to prevent the pages from tearing out.

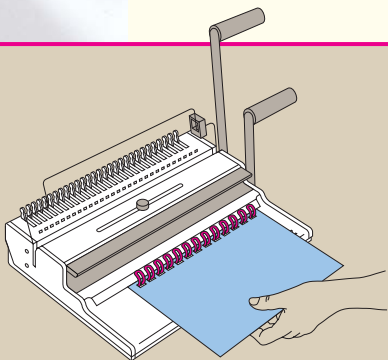
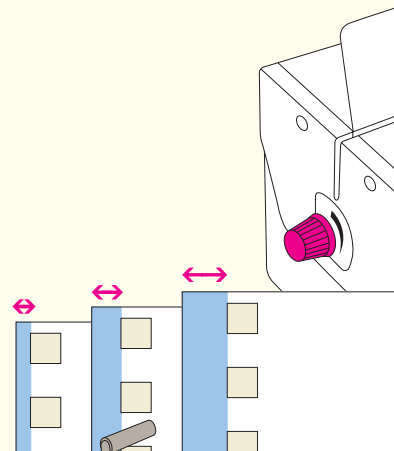

step 2
Select the wire comb, determined by the number of sheets, and place it onto the machine. Remove the punched paper from the punch and place it directly into the open wire comb. The horizontal closing mechanism prevents the pages from slipping out of the comb while closing.

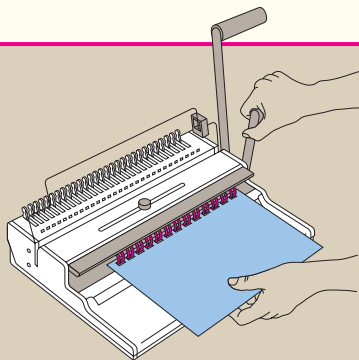

step 3
Place the assembled book into the open closing bars. Then pull the closing lever to close the wire.

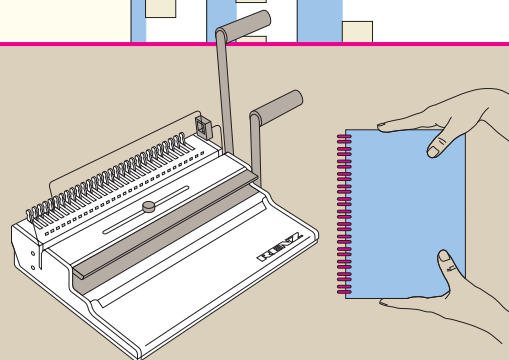

step 4
Finished. Remove the bound book.

ACCESSORIES



RENZ RING WIRE binding elements are available in nine colors [US = 8 colors] for book thicknesses up to 12 mm [1/2"]. Front covers in transparent colors, back covers in "chromolux" or in leather finish, filing strips, ...

- Advantages of the WirePack packaging:
- each WirePack sheet is labeled with the pitch and the diameter in inch and mm
 - the wire elements can be removed from the cardboard very easily using two fingers
 - the elements do not entangle while being taken off the WirePack sheet
 - the wire elements will not fall off the cardboard

Binding center with 4 WirePack sheets or with 2 WirePack sheets



WirePack

Pleister

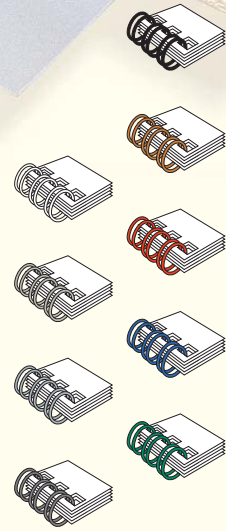

Order Nr. 49 472 0380

SPECIFICATIONS – AT A GLANCE

	RENZ RW	RENZ SRW	RENZ SRW Comfort	RENZ ERW
length, width, height	36, 55, 19 cm 14" x 22" x 7.5"	36, 55, 19 cm 14" x 22" x 7.5"	43, 57, 25 cm 17" x 22.5" x 10"	51, 55, 25 cm 20" x 22" x 10"
weight	13 kg [28.6 lb.]	13,5 kg [29.7 lb.]	28,5 kg [62.7 lb.]	39 kg [85.8 lb.]
disengageable punch pins	no	yes [all]	yes [all]	yes [all]
punching thickness	up to 2.5 mm/0.1", 25 sheets*	up to 2.5 mm/0.1", 25 sheets*	up to 2 mm/0.08", 20 sheets*	up to 2.5 mm/0.1", 25 sheets*
adjustable margin control	no	yes	yes	yes
binding thickness	up to 12 mm [1/2"] 120 sheets*	up to 12 mm [1/2"] 120 sheets*	up to 12 mm [1/2"] 120 sheets*	up to 12 mm [1/2"] 120 sheets*
Ø of the wire element	up to 14.3 mm [9/16"]	up to 14.3 mm [9/16"]	up to 14.3 mm [9/16"]	up to 14.3 mm [9/16"]
binding capacity	up to 250 books/hr	up to 250 books/hr	up to 280 books/hr	up to 300 books/hr
up to max. size	up to max. 30 cm A4 [12"], US [11"]	up to max. 34 cm [13.5"]	up to max. 34 cm [13.5"]	up to max. 34 cm [13.5"]
number of punch pins	34 [US model 32]	38	38	38
pitch	3:1	3:1	3:1	3:1
number of loops on A4 size [12"] on US size [11"]	34 32	34 32	34 32	34 32
punching capacity	up to 5,000 sheets/hr	up to 5,000 sheets/hr	up to 10,000 sheets/hr	up to 20,000 sheets/hr
motor			230 V, 50 Hz/90 W on request: 110V, 60 Hz/90 W	230 V, 50 Hz/250 W on request: 110V, 60 Hz/250 W

*70/80 g/m² paper, 20# stock

3:1

pitch

Ask us about machines in 2:1 pitch

800-658-8788

www.abcoffice.com

Free Manuals Download Website

<http://myh66.com>

<http://usermanuals.us>

<http://www.somanuals.com>

<http://www.4manuals.cc>

<http://www.manual-lib.com>

<http://www.404manual.com>

<http://www.luxmanual.com>

<http://aubethermostatmanual.com>

Golf course search by state

<http://golfingnear.com>

Email search by domain

<http://emailbydomain.com>

Auto manuals search

<http://auto.somanuals.com>

TV manuals search

<http://tv.somanuals.com>