

WA-50 Wireless Audio System



Instruction Manual

Limited Warranty

This warranty protects the owner of the Atlantic Technology Wireless WA-50-t and WA-50-r (the PRODUCT) for one (1) year from the date of purchase.

This warranty covers all defects in material and workmanship with the following specific exceptions. These are:

- Damage caused by improper installation or adjustment
- Damage caused by accident, unreasonable use or neglect
- Damage from failure to follow instructions contained in this Instruction Manual
- Damage occurring during shipment
- Damage from the performance of repairs by someone not authorized by Atlantic Technology
- Any unit on which the serial number has been effaced, modified, or removed
- Units which have been altered or modified in design, appearance or construction.

This warranty covers only the actual defects within the PRODUCT itself. IT DOES NOT cover costs of installation in (or removal from) a fixed installation, or normal setup, claims based on any misrepresentation by the seller, or performance variations resulting from installation related circumstances such as signal quality, AC power or incompatibilities with speakers and/or other system components.

During the warranty period, Atlantic Technology will, at its option, either repair the defect, or replace the defective product, or the defective parts, or components thereof at no charge to the owner for parts and labor covered by this warranty. If necessary repairs are not covered by this warranty, or if a unit is examined which is not in need of repair, you will be charged for the repairs and/or the examination. If non-warranted repairs are needed, we will notify you of the estimated cost and ask for your authorization to perform said repairs.

You must pay shipping charges incurred in getting your Product to the factory. We will pay the return shipping charges if the repairs are covered by the warranty. Please save the original shipping cartons, as the unit MUST be returned in the original carton and packing. (Replacement cartons are available at a modest charge.)

If your product needs service, please call Atlantic Technology at 781-762-6300.

You will need to present the original bill of sale to establish the date of purchase. In the event that the proof of purchase cannot be established with the original receipt, the warranty period shall be determined by the earliest date of manufacture shown on the unit.

In the event that you wish to return your Atlantic Technology Product back to us, for any reason, please call to arrange for a Return Authorization Number. This will ensure that your problem is discussed with a service technician who will determine if there is a quick solution to your problem.

Atlantic Technology shall not be liable for, in any way responsible for, any incidental or consequential damages of any kind. Some states do not allow limitations on how long an implied warranty lasts and/or do not allow the exclusion of incidental or consequential damages; therefore, the limitations and exclusions stated herein may not apply to you. This warranty gives you specific legal rights; and you may also have other rights that vary from state to state.

THERE ARE NO WARRANTIES GIVEN BY ATLANTIC TECHNOLOGY THAT EXTEND BEYOND THE DESCRIPTION GIVEN HEREIN. ANY IMPLIED WARRANTIES OF FITNESS FOR PURPOSE SOLD, MERCHANTABILITY, DESCRIPTION, QUALITY OR ANY OTHER MATTERS ARE LIMITED TO THE TERMS OF THE EXPRESSED LIMITED WARRANTY STATED HEREIN.

Products are sold on the basis of specifications applicable at the time of sales. Atlantic Technology shall have no obligation to modify products once they have been sold. This warranty is applicable only in the United States. For applicability in other countries, please call Atlantic Technology.



Safety Precautions



CAUTION: To reduce the risk of electric shock, do not remove the cover (or back). No user serviceable parts inside. Refer to qualified personnel.

WARNING: To reduce the risk of fire or electric shock, do not expose this appliance to rain or moisture. This device generates a fair amount of heat. Make sure nothing blocks the ventilation to the rear panel of the unit.



The lightning flash with arrowhead, within an equilateral triangle, is intended to alert the user to the presence of uninsulated "dangerous voltage" within the product's enclosure that may be of sufficient magnitude to constitute a risk of electrical shock to persons.



The exclamation point within an equilateral triangle is intended to alert the user to the presence of important operating maintenance (servicing) instructions in the literature accompanying the appliance.

The contents of this manual are Copyright © 2010 by Atlantic Technology International, Corp., and may not be duplicated or reproduced by any means, whether physical, electronic or otherwise without prior written consent from Atlantic Technology International, Corp.

Atlantic Technology and the Atlantic Technology logo are registered trademarks of Atlantic Technology International, Corp.

Specifications are those in effect at the time of printing. Atlantic Technology International, Corp. reserves the right to change specifications or designs at any time without notice without obligation to modify existing units.

Safety Instructions

- Read these instructions.
- Keep these instructions.
- Heed all warnings.
- Follow all instructions.
- Do not use this apparatus near water.
- Clean only with dry cloth.
- Do not block any ventilation openings. Install in accordance with the manufacturer's instructions.
- Do not install near any heat sources such as radiators, heat registers, stoves, or other apparatus that produce heat.
- Protect the power cord from being walked on or pinched particularly at plugs, convenience receptacles, and the point where they exit from the apparatus.
- Only use attachments/accessories specified by the manufacturer.
- Unplug this apparatus during lightning storms or when unused for long periods of time.
- Refer all servicing to qualified services personnel. Servicing

is required when the apparatus has been damaged in any way, such as power-supply cord or plug is damaged, liquid has been spilled or objects have fallen into the apparatus, the apparatus has been exposed to rain or moisture, does not operate normally, or has been dropped.

Adjust only those controls that are covered by the operating instructions as an improper adjustment of other controls may result in damage and will often require extensive work by a qualified technician to restore the apparatus to its normal operation

Damage Requiring Service

Unplug the apparatus from the wall outlet and refer servicing to qualified service personnel under the following conditions: When the power-supply cord or plug is damaged; If liquid has been spilled, or objects have fallen into the apparatus; If the apparatus has been exposed to rain or water; If the apparatus does not operate normally by

following the operating instructions; If the apparatus has been dropped or damaged in any way, and; When the apparatus exhibits a distinct change in performance this indicates a need for service.

Object and Liquid Entry

Never push objects of any kind into the apparatus through openings as they may touch dangerous voltage points or short-out parts that could result in a fire or electric shock. The apparatus shall not be exposed to dripping or splashing and no objects filled with liquids, such as vases shall be placed on the apparatus. Don't put candles or other burning objects on top of this unit.

This device has no power switch. To disconnect this device from power supply, the power cord must be disconnected.

The power supply and power cord for this apparatus is intended for indoor use only.

Only use the included A/C adaptor.

WA-50 Wireless Audio System

Congratulations on the purchase of an Atlantic Technology WA-50 Wireless Audio System. Never before has it been so easy to distribute audio from one location in your home or business to another than it is right now.

In this document, we will walk you through the installation of the WA-50 system in just a few of the configurations that are possible with this high performance wireless audio distribution system.

Specifications

- Wireless full CD quality sound
- Robust and dedicated network for your audio
- Easy setup, get wireless music in seconds
- Wireless range up to 50 m.; 100 m in line of sight
- No interference or delays
- Time delay max 10ms
- Works with both Mac & PC
- Plug'n play - No software needed
- Flexible multi-zone functionality
- RF band: 2.4GHz
- Dedicated proprietary protocol
- USB 2.0 interface
- SNR: 93dB

Package Content

Your WA-50 Wireless Audio System ships with this Instruction Manual and the following items:

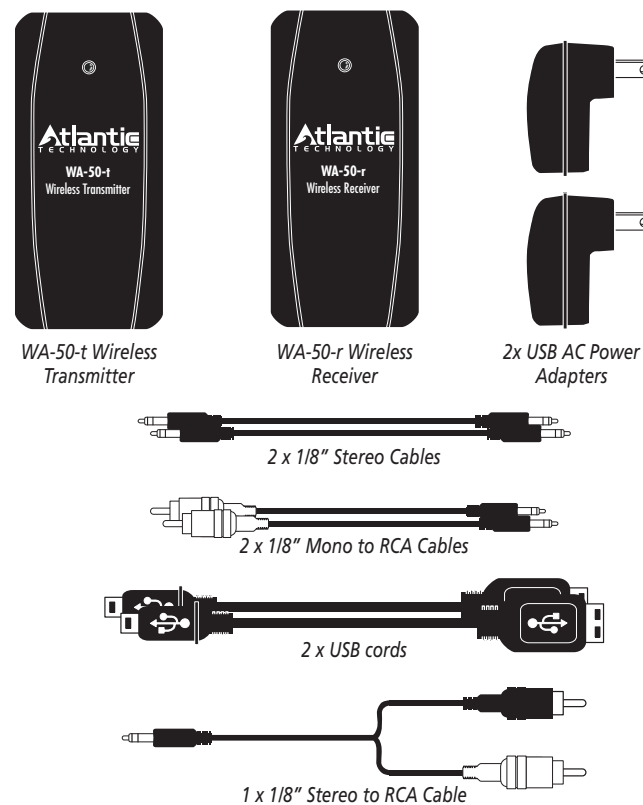

NOTE: Please contact customer service if any of these items are missing.

FCC Compliance

This device complies with Part 15 of the FCC Rules. Operation is subject to the following two conditions: (1) this device may not cause harmful interference, and (2) this device must accept any interference received, including interference that may cause undesired operation

Changes or modifications not expressly approved by the party responsible for compliance could void the user's authority to operate the equipment.

This equipment has been tested and found to comply with the limits for a Class B digital device, pursuant to part 15 of the FCC Rules. These limits are designed to provide reasonable protection against harmful interference in a residential installation. This equipment generates and can radiate radio frequency energy and, if not installed and used in accordance with the instructions, may cause harmful interference to radio communications. However, there is no guarantee that interference will not occur in a particular installation. If this equipment does cause harmful interference to radio or television reception, which can be determined by turning the equipment off and on, the user is encouraged to try to correct the interference by one or more of the following measures:

- Increase the separation between the equipment and receiver.
- Connect the equipment into an outlet on a circuit different from that to which the receiver is connected.

To satisfy FCC RF exposure requirements, a separation distance of 20 cm or more should be maintained between this device and persons during device operation.

To ensure compliance, operations at closer than this distance is not recommended. The antenna used for this transmitter must not be co-located in conjunction with any other antenna or transmitter.

Troubleshooting Guide

Once your subwoofer is set up, you should have many years of maintenance free enjoyment from your system. However, if you should encounter a problem, refer to the following guide to help you find the solution. If a problem persists, you should contact your local authorized Atlantic Technology dealer.

Problem	Solutions
WA-50-t and/or WA-50-r are connected but Status LED does not light up	a. Make sure both transmitter and receiver are connected to a power supply b. USB 2.0 connection on receiver or processor is being used for power c. Switch to supplied USB AC Adapter
No Wireless Connection (WA-50-t and WA-50-r Status lights are "Red")	a. Make sure your WA-50-t and WA-50-r are both set to the same "Zone" b. WA-50-r may be out of range. Try moving the receiver closer
Your WA-50-t and WA-50-r are connected, but no audio occurs	a. Ensure that your source components are functioning properly b. Ensure that the audio levels are configured for audible output (volume at source and/or destination may be muted or turned too low) c. If source component is computer, be sure the USB Headset is still listed as Default Playback Device (See PC and MAC configuration)

Connections and Configurations

Figure 1

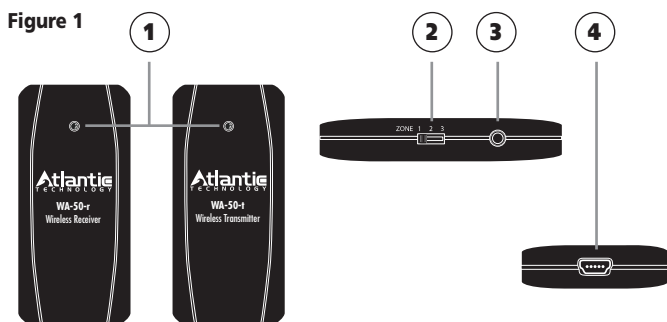

1 Status LED

Indicates power and synch status between the WA-50-t and WA-50-r wireless components

2 Zone Switch

Three position switch that sets the communication channel between the WA-50-t and WA-50-r wireless components

3 Analog I/O Port

1/8" Analog Stereo I/O (input/output) Port-Connect audio cables here (not required when using USB direct to a computer or media server)

4 Mini USB Port

Connect supplied USB cable here as well as to the supplied power adapter or USB I/O on your computer

AV Receiver or Processor to Subwoofer

Part 1: WA-50-t Wireless Transmitter

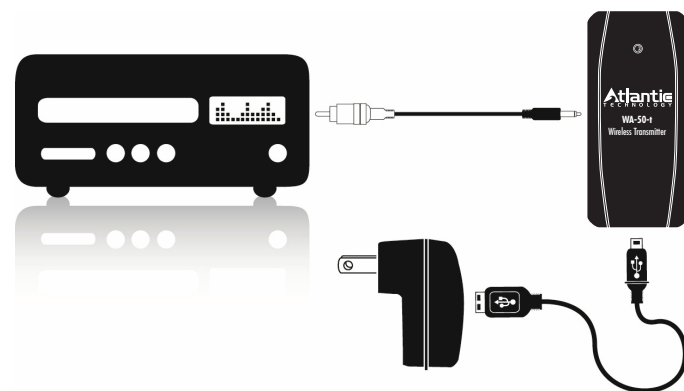

1. Connect supplied USB cable's Mini-USB connector to the WA-50-t.
2. Connect the standard USB connector to the supplied USB AC adapter.
3. Select the "Zone" setting you wish to use when transmitting audio to your wireless powered subwoofer.
4. Connect the 1/8" mono connector into the 1/8" stereo jack on the WA-50-t.
5. Connect the Yellow RCA connector to your receiver or processor's sub-woofer/LFE output.

Part 2: WA-50-r Wireless Receiver

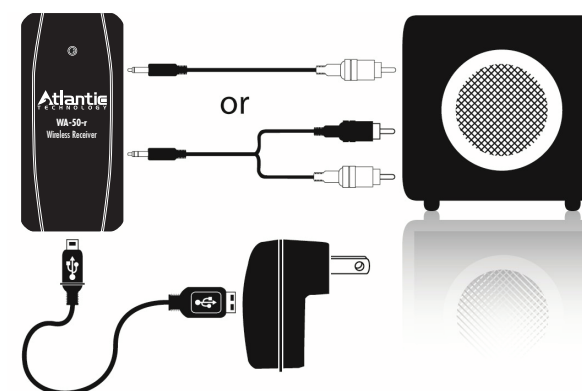

1. Connect supplied USB cable's Mini-USB connector to the WA-50-r.
2. Connect the standard USB connector to the supplied USB AC adapter.
3. Select the WA-50-r "Zone" setting that corresponds with the "Zone" setting used on your WA-50-t.
4. Connect the 1/8" mono connector into the 1/8" stereo jack on the WA-50-r for use with an LFE/mono input on your powered subwoofer, or the 1/8" Stereo connector for powered subwoofers with stereo RCA inputs.
5. Connect the Yellow RCA connector or Red/White stereo RCA connectors to your powered subwoofer. Consult your receiver/processor as well as your subwoofer owner's manuals for the proper configuration of your subwoofer.
6. You are now ready to enjoy your "wireless" powered subwoofer!

Computer/Media Server Connections

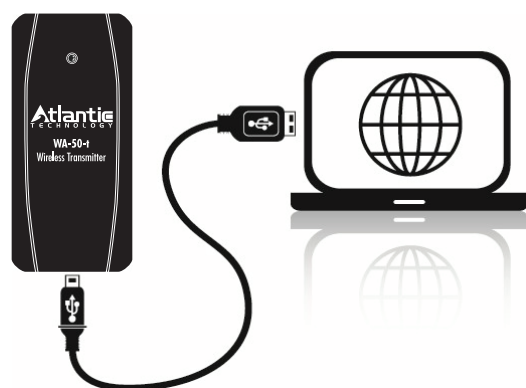

PC Configurations

1. Connect supplied USB cables Mini-USB connector to the WA-50-t
2. Select the "Zone" setting you wish to use when transmitting audio to your WA-50-r wireless receiver.
3. Connect the standard USB connector to an open port on your PC.
4. WA-50-t status light will rapidly alternate between red and blue, finally settling on red after a 3-5 second synchronization scan.
5. Your PC will automatically recognized the WA-50-t as a USB Audio Device. Please allow your PC to finish the installation process before proceeding. A message will appear in the bottom right corner of your desktop stating "Your new hardware is installed and ready to use."
6. Your WA-50-t will be now configured as your computer or media server's default audio playback device.

NOTE: It may be necessary to manually select USB Headset as the default audio device under the audio tab of your computer's Sound and Audio s Devices menu located in the computer's Control Panel.

Apple/Mac Configuration

1. Connect supplied USB cable's Mini-USB connector to the WA-50-t.
2. Select the "Zone" setting you wish to use when transmitting audio to your wireless receiver.
3. Connect the standard USB connector to an open port on your Mac computer.
4. WA-50-t status light will rapidly alternate between red and blue lights until it settles on red after a 3-5 second synchronization scan.
5. Click on System Preferences and select "Sound" under the "Hardware" menu.
6. Click "Output" and manually select "USB Headset".
7. Your WA-50-t will now be configured as the default audio play-back device on your Mac computer.

Computer to AV Receiver or Processor

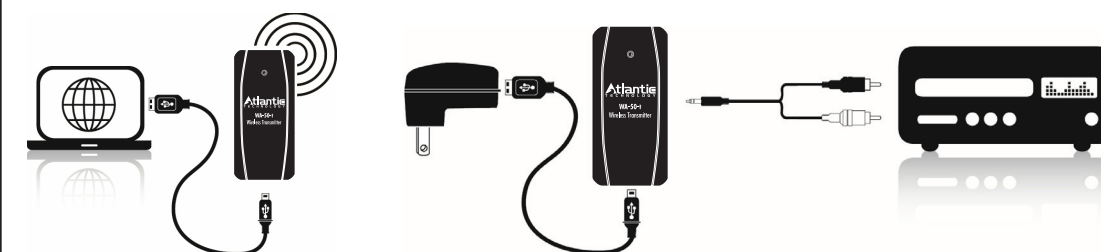

Now that your PC or Mac computer is configured to stream audio from the Atlantic Technology WA-50-t wireless transmitter, you will now need to connect the WA-50-r to your audio system.

1. Connect supplied USB cable's Mini-USB connector to the WA-50-r.
2. Connect the standard USB connector to the supplied USB AC adapter.
3. Select the WA-50-r "Zone" setting that corresponds with the "Zone" setting used on your WA-50-t.
4. Connect the 1/8" stereo connector into the 1/8" stereo jack on the WA-50-r.
5. Connect the RCA cables to an unused input on your AV Receiver. Consult your receiver or processor owner's manual for proper configuration of this input. (Note: Be certain that the power is turned off on your AV Receiver prior to making audio connections.)

Connect the USB AC adapter to a power source and begin streaming audio!

Free Manuals Download Website

<http://myh66.com>

<http://usermanuals.us>

<http://www.somanuals.com>

<http://www.4manuals.cc>

<http://www.manual-lib.com>

<http://www.404manual.com>

<http://www.luxmanual.com>

<http://aubethermostatmanual.com>

Golf course search by state

<http://golfingnear.com>

Email search by domain

<http://emailbydomain.com>

Auto manuals search

<http://auto.somanuals.com>

TV manuals search

<http://tv.somanuals.com>