

# SMT Power Inductor (MOLDING TYPE)

## MPO10X Type

### Features

- RoHS compliant.
- Low profile, high current SMD type.
- Frequency range up to 1MHz.
- Lowest DCR/ $\mu$ H, in this package size.
- Low buzz noise due to its gap-less structure.

### Applications

- Notebook/Desktop/Server/Video Card applications.
- High current POL converters.
- Low profile, high current power supplies.
- Battery powered devices.
- Ideal for power source circuits, DC-DC converter.
- DC-AC inverters inductor application.

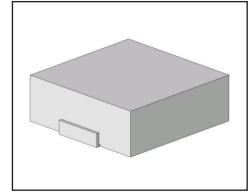

### Mechanical Dimension:

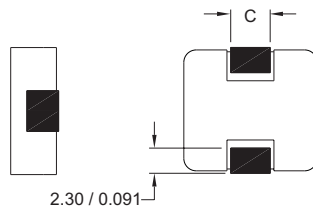
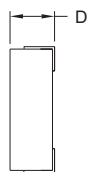
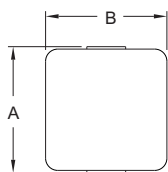

### RECOMMENDED PAD PATTERNS

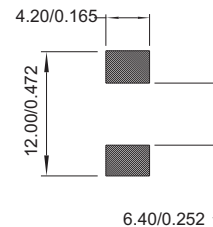

UNIT : mm/inch  
 A = 11.50 / 0.453 Max.  
 B = 10.00 $\pm$ 0.30 / 0.394 $\pm$ 0.012

### Electrical Characteristics: At 25°C: 100KHz, 0.25V

PART NO.	Lo <sup>1</sup> ( $\mu$ H)	DCR (m $\Omega$ ) TYP.	DCR (m $\Omega$ ) MAX.	Isat <sup>1</sup> (Adc)	Ir <sup>2</sup> (Adc)	Dimension "C" mm / inch $\pm$ 0.5 / $\pm$ 0.02	Dimension "D" mm / inch MAX
MPO1035-R68	0.68 $\pm$ 20%	2.30	2.80	38	25	2.3 / 0.091	3.5 / 0.138
MPO1035-1R0	1.00 $\pm$ 20%	3.35	3.80	26	21	2.0 / 0.079	3.5 / 0.138
MPO104-R36	0.36 $\pm$ 20%	1.08	1.20	45	30	3.5 / 0.138	4.0 / 0.157
MPO104-R39	0.39 $\pm$ 20%	1.08	1.20	35	30	3.5 / 0.138	4.0 / 0.157
MPO104-R45-C	0.45 $\pm$ 20%	1.25	1.45	35	30	3.5 / 0.138	4.0 / 0.157
MPO104-R56	0.56 $\pm$ 20%	1.60	1.80	25	36	3.0 / 0.118	4.0 / 0.157
MPO104-1R0	1.00 $\pm$ 20%	2.80	3.00	30	21	2.6 / 0.103	4.0 / 0.157
MPO104-1R5	1.50 $\pm$ 20%	3.80	4.20	33	20	2.3 / 0.091	4.0 / 0.157

1. Isat is the DC current which cause the inductance drop approximately 30% of its nominal inductance without current.
3. Ir is the DC current which cause the surface temperature of the part increase approximately than 40°C.



DELTA ELECTRONICS, INC.

(TAOYUAN PLANT CPBG) 252, SAN YING ROAD, KUEISAN INDUSTRIAL ZONE, TAOYUAN SHIEN, 333, TAIWAN, R.O.C.

TEL: 886-3-3591968; FAX: 886-3-3591991

<http://www.deltawww.com>

## Free Manuals Download Website

<http://myh66.com>

<http://usermanuals.us>

<http://www.somanuals.com>

<http://www.4manuals.cc>

<http://www.manual-lib.com>

<http://www.404manual.com>

<http://www.luxmanual.com>

<http://aubethermostatmanual.com>

Golf course search by state

<http://golfingnear.com>

Email search by domain

<http://emailbydomain.com>

Auto manuals search

<http://auto.somanuals.com>

TV manuals search

<http://tv.somanuals.com>